



PARKVIEW CF00062OFR51-ORA51 **Module to visualize the Aftermarket Parking Sensors** **FRONT REAR COBRA PS0158** **INSTALLATION MANUAL**



DESCRIPTION

PARKVIEW is an electronic module, easy to install, that allows you to integrate professionally aftermarket parking sensors on vehicles compatibles equipped with the OEM radio.

The device allows to display on the OEM radio display the signalling of the parking sensors as it happens for the OEM parking sensors.

The kit is composed by two special PARKVIEW module and the harnesses for the connection. The installation is simple.

Once installed the parking sensors kit, connect PARKVIEW modules as described in the following diagram.

VOLKSWAGEN

BEFORE STARTING INSTALLATION, PLEASE ENABLE THE PARKING SENSOR FUNCTION OF THE CAR, THROUGH THE VOLKSWAGEN DIAGNOSIS TOLL ODIS

CONNECTIONS

After making the connections, connect the Parking Sensor KIT BUZZER and the PARKVIEW wiring connector B and calibrate the Cobra system as usual.

After making the connections, connect the Parking Sensor KIT BUZZER and the PARKVIEW wiring connector B and calibrate the Cobra system as usual.

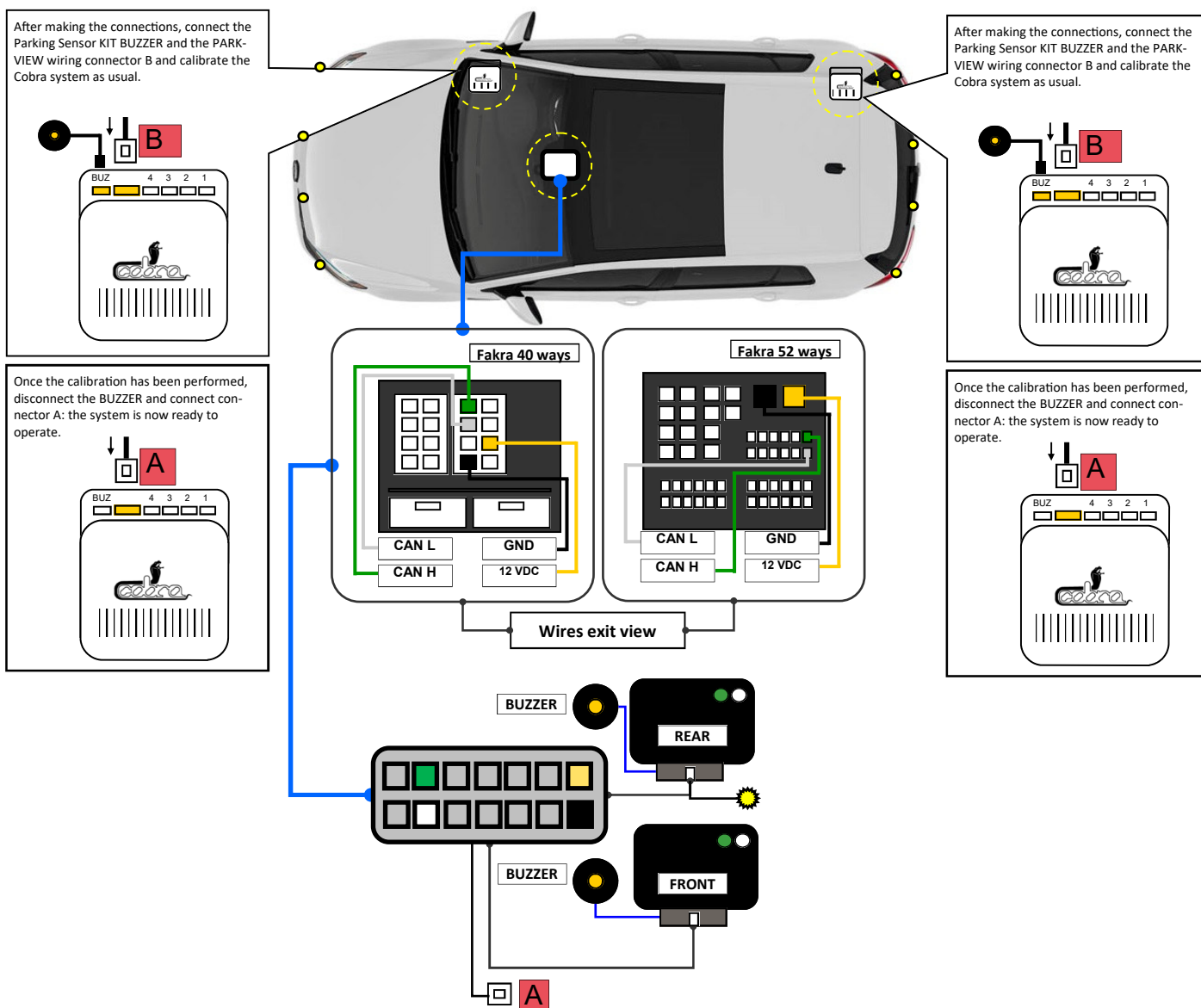



PARKVIEW CF00062OFR51-ORA51 **Module to visualize the Aftermarket Parking Sensors** **FRONT REAR COBRA PS0158** **INSTALLATION MANUAL**

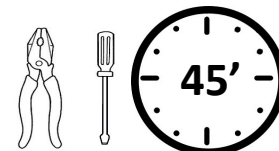

The harness supplied with PARKVIEW is split in 2 sections: the first is composed by 4 wires to connect back the OEM radio of the vehicle.

In the QUADLOCK plug it must to connect:

YELLOW to the +12vdc positive wire

BLACK to the GND negative wire

GREEN to the CAN H

WHITE to the CAN L

PINK to the power of the parking sensor

The diagram above suggests the ho to manage the connections, the QUADLOCK plug is seen from the wire output side.

The second section of the harness is a kind of extension long 5 mts that must to lay down till the boot, where is located the parking sensors device.

Then connect the 4 poles white MOLEX plug to the DISPLAY connector of the parking sensors as above described.

In the kit there are 2 module one for the rear one for the front, the connection are both for Parkview modules;

For both modules the buzzer used is the one in the cable so do not use the one of the kit.

Once the connections have been made, the system will be working immediately, the PARKVIEW LED will be GREEN when the car canbus is switched on, indicating that the module is working correctly.

When reverse gear is engaged, the parking sensor control unit will be activated, automatically PARKVIEW will activate the display on the original radio. On some radio models, the MUTE radio is also managed on the display. When reverse gear is removed, the display will be interrupted.

RCD 310

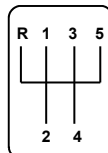
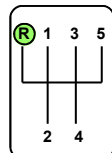

Switching on the parking sensors, Parkview led will generate some red/green flashes, confirming the right working.

ALTERNATIVE CONNECTION DRIVER SIDE

After making the connections, connect the Parking Sensor KIT BUZZER and the PARKVIEW wiring connector B and calibrate the Cobra system as usual.

After making the connections, connect the Parking Sensor KIT BUZZER and the PARKVIEW wiring connector B and calibrate the Cobra system as usual.

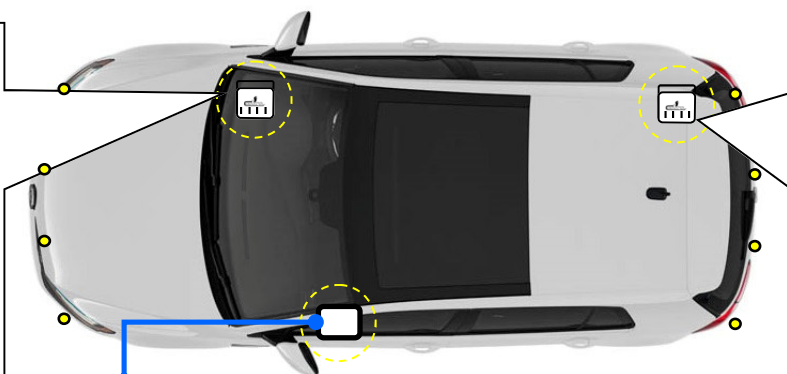

Once the calibration has been performed, disconnect the BUZZER and connect connector A: the system is now ready to operate.

Once the calibration has been performed, disconnect the BUZZER and connect connector A: the system is now ready to operate.

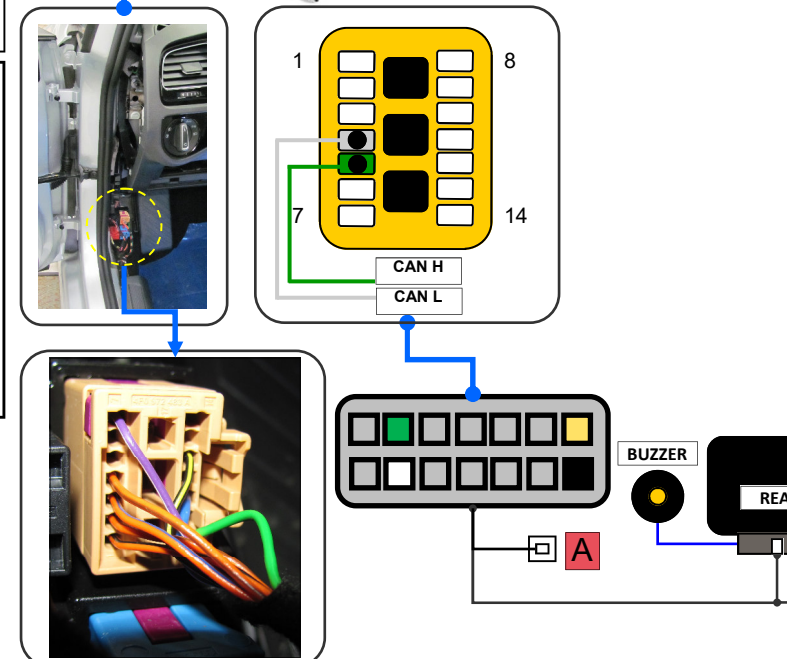

	<p align="center">PARKVIEW CF00062OFR51-ORA51 Module to visualize the Aftermarket Parking Sensors FRONT REAR COBRA PS0158 INSTALLATION MANUAL</p>	 
---	---	---

AUDI A1 CONNECTION

Connect:

YELLOW to the +12vdc positive RED big size wire located down the dashboard
BLACK to the GND negative wire to the chassis of the vehicle directly
GREEN to the CAN H position 5 of the OEM yellow connector
WHITE to the CAN L position 4 of the OEM yellow connector
PINK to the power of the parking sensor

After making the connections, connect the Parking Sensor KIT BUZZER and the PARK-VIEW wiring connector B and calibrate the Cobra system as usual.

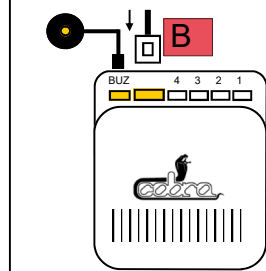

Once the calibration has been performed, disconnect the BUZZER and connect connector A: the system is now ready to operate.

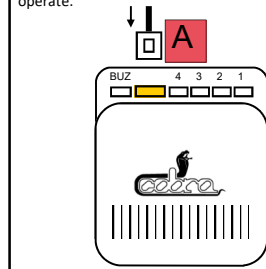

After making the connections, connect the Parking Sensor KIT BUZZER and the PARK-VIEW wiring connector B and calibrate the Cobra system as usual.

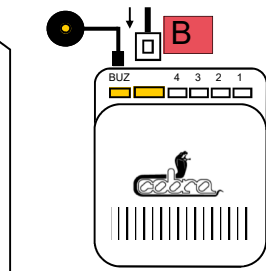

Once the calibration has been performed, disconnect the BUZZER and connect connector A: the system is now ready to operate.

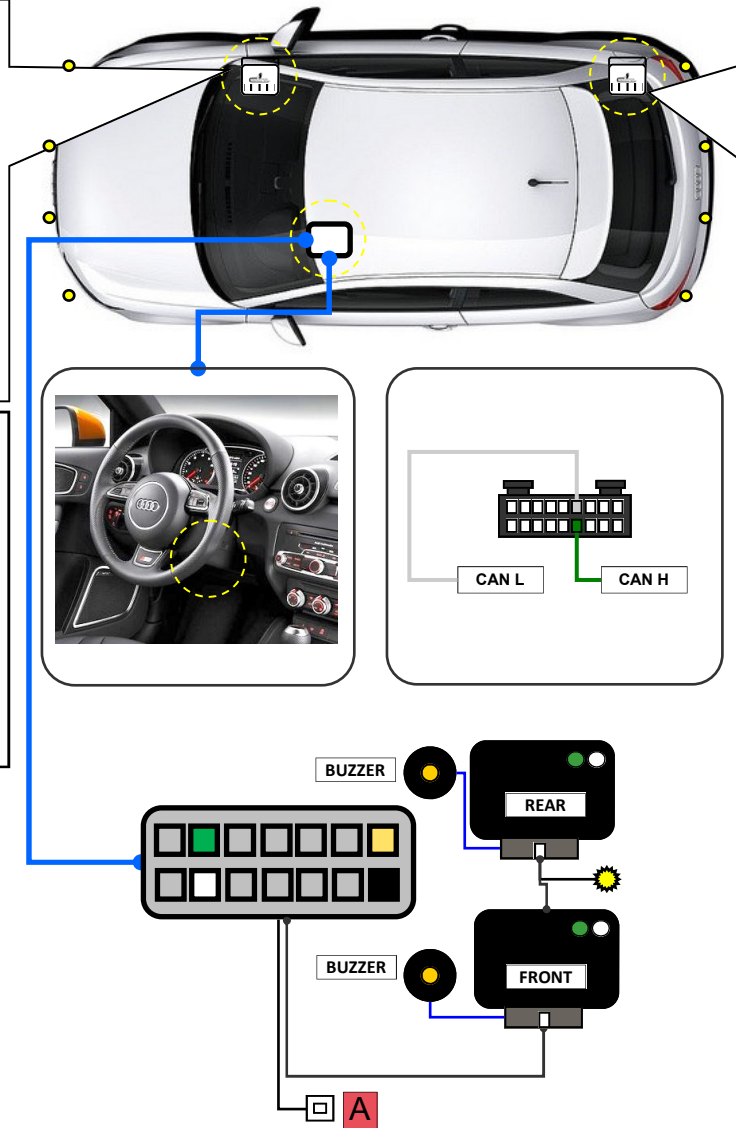
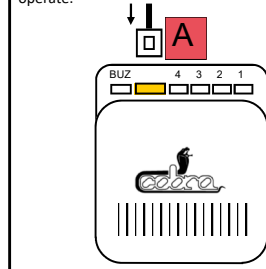

**THE SYSTEM STARTS TO WORK BY INSERTING THE BACK GEAR.
THE SYSTEM SWITCHES OFF BY REMOVING THE BACK GEAR AND ONCE OVER PASSED 10 KMH.**

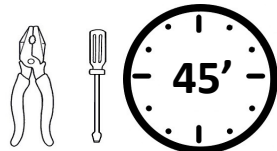
	<p align="center">PARKVIEW CF00062OFR51-ORA51 Module to visualize the Aftermarket Parking Sensors FRONT REAR COBRA PS0158 INSTALLATION MANUAL</p>	
---	---	---

PDC MANUAL ACTIVATION / DEACTIVATION

If the car is equipped of steering wheel commands, by pressing for 3 seconds OK button, PDC is switched ON or OFF based on the last status. This operation is possible if car is driving below 10 km/h speed.

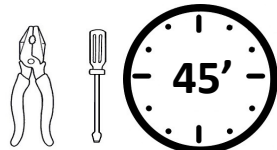

CAR	YEAR	RADIO COMPATIBLE
VOLKSWAGEN		
POLO	From 2010 to 2013	RCD310 - RCD315 - RCD510 - RNS310 - RNS315 - RNS 510
POLO	From 2014	MIB ENTRY - MIB STANDARD
GOLF VI	From 2009	RCD310 - RCD315 - RCD510 - RNS310 - RNS315 - RNS 510
GOLF PLUS	From 2009	RCD310 - RCD315 - RCD510 - RNS310 - RNS315 - RNS 510
GOLF VARIANT	From 2009	RCD310 - RCD315 - RCD510 - RNS310 - RNS315 - RNS 510
SCIROCCO	From 2009	RCD310 - RCD315 - RCD510 - RNS310 - RNS315 - RNS 510
JETTA	From 2010	RCD310 - RCD315 - RCD510 - RNS310 - RNS315 - RNS 510
NUOVA TOURAN	From 2010	RCD310 - RCD315 - RCD510 - RNS310 - RNS315 - RNS 510
NUOVA SHARAN	From 2010	RCD310 - RCD315 - RCD510 - RNS310 - RNS315 - RNS 510
TIGUAN	From 2009	RCD310 - RCD315 - RCD510 - RNS310 - RNS315 - RNS 510
EOS	From 2009	RCD310 - RCD315 - RCD510 - RNS310 - RNS315 - RNS 510
PASSAT	From 2009	RCD310 - RCD315 - RCD510 - RNS310 - RNS315 - RNS 510
PASSAT VARIANT	From 2009	RCD310 - RCD315 - RCD510 - RNS310 - RNS315 - RNS 510
NUOVA PASSAT	From 2010	RCD310 - RCD315 - RCD510 - RNS310 - RNS315 - RNS 510
NUOVA PASSAT VARIANT	From 2010	RCD310 - RCD315 - RCD510 - RNS310 - RNS315 - RNS 510
PASSAT CC	From 2009	RCD310 - RCD315 - RCD510 - RNS310 - RNS315 - RNS 510
NUOVO CADDY	From 2010	RCD310 - RCD315 - RCD510 - RNS310 - RNS315 - RNS 510
MULTIVAN	From 2010	RCD310 - RCD315 - RCD510 - RNS310 - RNS315 - RNS 510
NEW BEETLE	From 2012	RCD310 - RCD315 - RCD510 - RNS310 - RNS315 - RNS 510
AMAROK	From 2013	RCD310 - RCD315 - RCD510 - RNS310 - RNS315 - RNS 510
GOLF VII	From 2013	MIB ENTRY - MIB STANDARD
SEAT		
ALTEA	From 2011	RCD310 - RCD315 - RNS310 - RNS315
LEON	From 2011 to 2012	RCD310 - RCD315 - RNS310 - RNS315
LEON	From 2013	MEDIA SYSTEM COLOR - MEDIA SYSTEM PLUS MEDIA SYSTEM NAVIGATION
ALHAMBRA	From 2011	RCD310 - RCD315 - RNS310 - RNS315
TOLEDO	From 2015	SEAT MEDIA SYSTEM
SKODA		
FABIA	From 2011	SWING - RNS AMUNDSEN
ROOMSTER	From 2011	SWING - RNS AMUNDSEN
OCTAVIA	From 2011 to 2012	SWING - RNS AMUNDSEN
OCTAVIA	From 2013	BOLERO - BOLERO PLUS - NAVI AMUNDSEN
YETI	From 2011	SWING - RNS AMUNDSEN
SUPERB	From 2011	SWING - RNS AMUNDSEN
AUDI		
A1	From 2014	RADIO MMI
A3	From 2014	RADIO MMI

	<p align="center">PARKVIEW CF00062OFR51-ORA51 Module to visualize the Aftermarket Parking Sensors FRONT REAR <u>COBRA PS0158</u> INSTALLATION MANUAL</p>	
---	---	---

ATTENTION

POWER THE PARKING SENSOR CONTROL UNIT WITH THE PINK CABLE OF MODULES, FOLLOWING THE PDC INSTRUCTION MANUAL.

THE SYSTEM WORKS WITH THE IGNITION ON.

THE SYSTEM IS ACTIVATED BY INSERTING THE REVERSE AND DEACTIVATED BY REMOVING THE REVERSE.

IF YOU WANT TO INSTALL THE MODULE ON A NEW CAR, IT IS NECESSARY TO EXECUTE THE MODULE RESET.

RESET:

1. WITH THE UNIT POWERED, PRESS AND HOLD THE MODULE BUTTON UNTIL THE LED SWITCHES OFF.
2. WITH THE LED OFF, RELEASE THE BUTTON: THE RESET IS DONE.

TROUBLESHOOTING**Parking Sensor UNIT**

PROBLEM	CAUSE	SOLUTION
The system doesn't work when the back gear is inserted.	Wrong connection of the power wires	Power the parking sensors through the Parkview
	Wrong connection of the plugs	Verify the connection of the connectors of the parking system
The system detects always the obstacle	The system detects the ground	Verify that the sensors caps are installed horizontally respect the ground.
	Caps sensors are varnished incorrectly	Verify that the caps varnish layer is not too thick. In this case the sensors can detect it as an obstacle.
	The test is made in closed space	Please make the test of the system in an open space and not into a close room.
The sound of the buzzer is not available	Wrong connections of the caps sensors	Please control the caps sensors connection

PARKVIEW

PROBLEM	CAUSE	SOLUTION
The unit doesn't manage any function and the LED is OFF.	Wrong connection of the power wires	Verify the power connections
The unit is right connected but it doesn't manage any function and the LED is OFF.	Wrong connection of the CANBUS wires	Verify the CANBUS connections
The unit is right connected and the LED blinks RED quickly.	CANBUS protocol unknown or upgraded by the car manufacturer	The unit is not able to synchronize the CANBUS protocol; please contact the distributor
The unit is right connected and the LED blinks RED irregularly.	Wrong connection of the CANBUS wires	Verify the CANBUS connections
The unit is right connected and the LED switches on RED.	CANBUS protocol unknown or upgraded by the car manufacturer	The unit is not able to synchronize the CANBUS protocol; please contact the distributor

Technical features

POWER	10/16 VDC
SLEEP MODE ABSORPTION	<1 mA
WORKING MODE ABSORPTION	1 A

WARRANTY

**THIS PRODUCT IS GUARANTEED FOR 2 YEARS FOR ANY MANUFACTURING DEFECTS.
THE FISCAL DOCUMENT SERVES AS THE GUARANTEE VALIDITY**

The information in this guide are purely for information purposes, therefore, are subject to change without notice. At the time of publication the information is correct and reliable. However Paser can not be held responsible for any consequences resulting from errors or omissions in this manual. Paser reserves the right to improve / change the product or manual without obligation to notify users.