



PARKVIEW CF0006UNPS41

CANBUS MODULE TO VIZUALIZE PDC ON CAR DISPLAY

Laserline EPS4006-D, ES404B, EPS4012, EPS4012-NU e Paser AFREPS4006-D, AFREPS404B, AFR600RAPS11.

INSTALLATION MANUAL



DESCRIPTION

PARKVIEW is an electronic module easy to install, that allows you to integrate professionally aftermarket parking sensors on the vehicles equipped with the OEM radio.

The device allows to display on the OEM radio the parking operation as it happens for the OEM parking sensors.

VOLKSWAGEN

BEFORE STARTING INSTALLATION, PLEASE ENABLE THE PARKING SENSOR FUNCTION ON THE VEHICLE BY USING OFFICAL VW DISGNOSTIC DEVICE ODIS.

CONNECTIONS

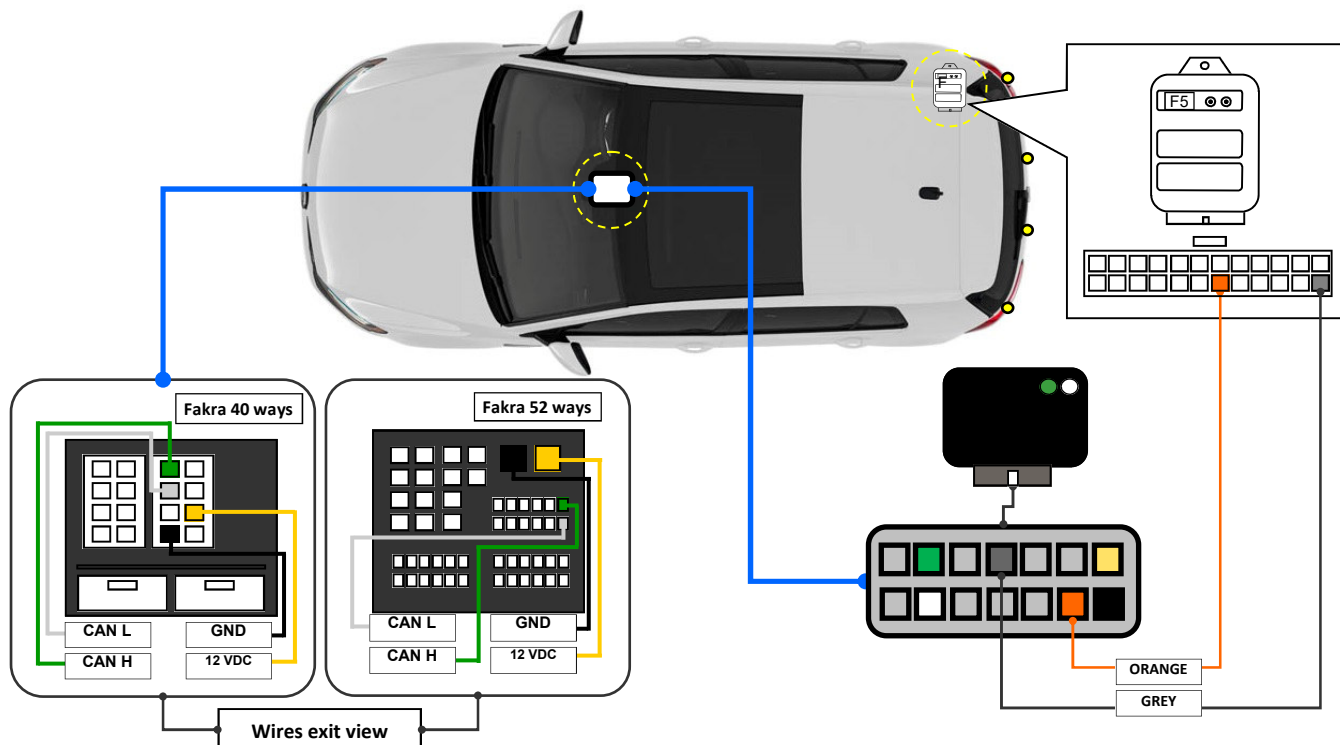

The harness supplied with PARKVIEW is split in 2 sections, the first is composed by 4 wires to connect back the OEM radio of the vehicle. In the FAKRA plug it must to connect:

YELLOW to the +12vdc positive wire
BLACK to the GND negative wire
GREEN to the CAN H
WHITE to the CAN L

The diagram above suggests how to make the connections, FAKRA plug is seen from wires exit side.

Second section of the harness is the 5 mt long extension that must to lay down till the boot where is located the parking sensors device. Then connect the terminals ORANGE and GREY in the connector of the parking sensors as above described.

Please use the BUZZER of the parking sensors. To power the parking sensors please connect it to the reverse lamp.

Once the connection are done the system is immediately ready to work, each time the canbus line will wake up the LED of PARKVIEW will light GREEN to indicate the correct behaviour of the module. Then by inserting the reverse parking sensors will activate, consequently PARKVIEW will activate the visualizing on the OEM radio. With some radio MUTE is managed directly by the radio. By removing the back gear the visualizing will be interrupted.

RCD 310

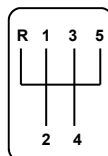
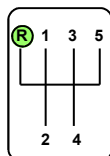

By switching on the parking sensors, Parkview led will generate some red/green flashes confirming the right working.



PARKVIEW CF0006UNPS41

CANBUS MODULE TO VIZUALIZE PDC ON CAR DISPLAY

Laserline EPS4006-D, ES404B, EPS4012, EPS4012-NU e Paser AFREPS4006-D, AFREPS404B, AFR600RAPS11.

INSTALLATION MANUAL



ALTERNATIVE CONNECTION ON DRIVER DOOR SIDE

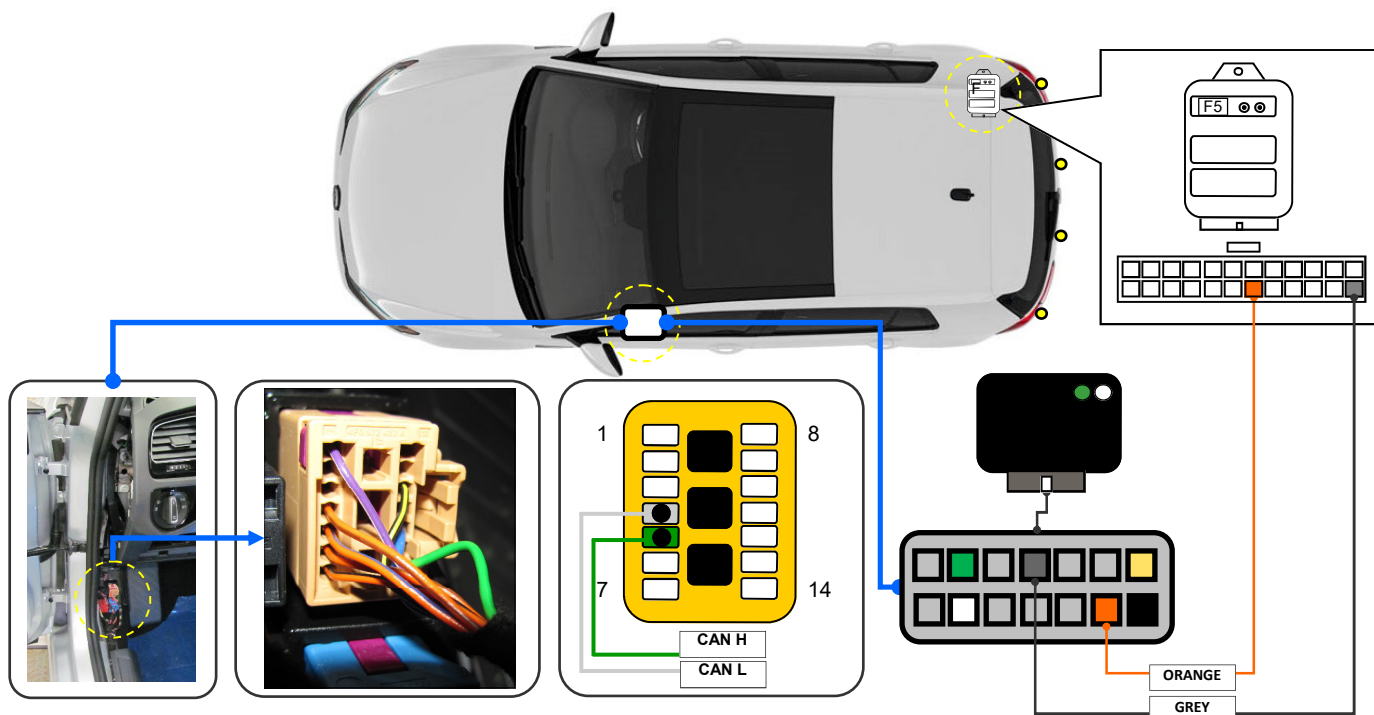

Connections:

YELLOW to the +12vdc positive RED big size wire located down the dashboard

BLACK to the GND negative wire to the chassis of the vehicle directly

GREEN to the CAN H position 5 of the OEM yellow connector

WHITE to the CAN L position 4 of the OEM yellow connector

Please use the BUZZER of the parking sensors. To power the parking sensors please connect it to the reverse lamp.

CONNECTION ON AUDI A1

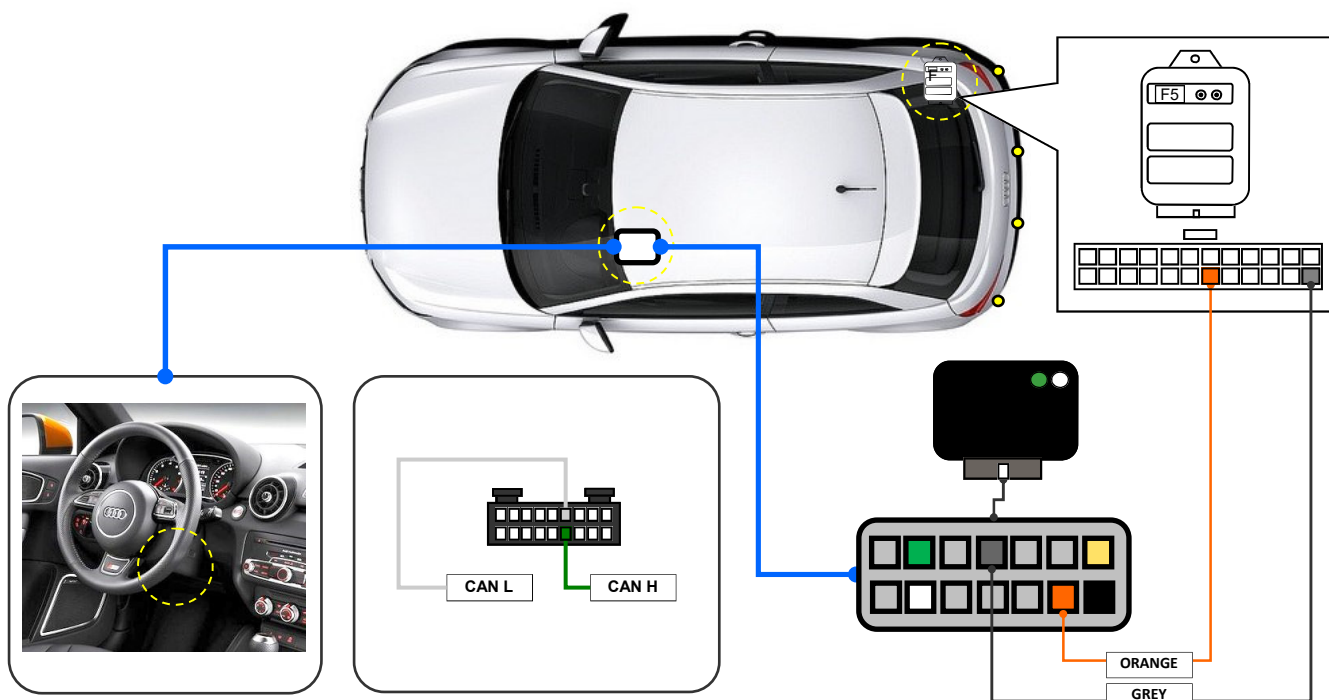

SYSTEM WORKS WITH THE IGNITION ON.

SYSTEM STARTS TO WORK BY INSERTING THE REVERSE AND IT SWITCHES OFF BY REMOVING THE REVERSE.



PARKVIEW CF0006UNPS41

CANBUS MODULE TO VIZUALIZE PDC ON CAR DISPLAY

Laserline EPS4006-D, ES404B, EPS4012, EPS4012-NU e Paser AFREPS4006-D, AFREPS404B, AFR600RAP511.

INSTALLATION MANUAL



CAR	YEAR	RADIO COMPATIBLE
VOLKSWAGEN		
POLO	From 2010 to 2013	RCD310 - RCD315 - RCD510 - RNS310 - RNS315 - RNS 510
POLO	From 2014	MIB ENTRY - MIB STANDARD
GOLF VI	From 2009	RCD310 - RCD315 - RCD510 - RNS310 - RNS315 - RNS 510
GOLF PLUS	From 2009	RCD310 - RCD315 - RCD510 - RNS310 - RNS315 - RNS 510
GOLF VARIANT	From 2009	RCD310 - RCD315 - RCD510 - RNS310 - RNS315 - RNS 510
SCIROCCO	From 2009	RCD310 - RCD315 - RCD510 - RNS310 - RNS315 - RNS 510
JETTA	From 2010	RCD310 - RCD315 - RCD510 - RNS310 - RNS315 - RNS 510
NUOVA TOURAN	From 2010	RCD310 - RCD315 - RCD510 - RNS310 - RNS315 - RNS 510
NUOVA SHARAN	From 2010	RCD310 - RCD315 - RCD510 - RNS310 - RNS315 - RNS 510
TIGUAN	From 2009	RCD310 - RCD315 - RCD510 - RNS310 - RNS315 - RNS 510
EOS	From 2009	RCD310 - RCD315 - RCD510 - RNS310 - RNS315 - RNS 510
PASSAT	From 2009	RCD310 - RCD315 - RCD510 - RNS310 - RNS315 - RNS 510
PASSAT VARIANT	From 2009	RCD310 - RCD315 - RCD510 - RNS310 - RNS315 - RNS 510
NUOVA PASSAT	From 2010	RCD310 - RCD315 - RCD510 - RNS310 - RNS315 - RNS 510
NUOVA PASSAT VARIANT	From 2010	RCD310 - RCD315 - RCD510 - RNS310 - RNS315 - RNS 510
PASSAT CC	From 2009	RCD310 - RCD315 - RCD510 - RNS310 - RNS315 - RNS 510
NUOVO CADDY	From 2010	RCD310 - RCD315 - RCD510 - RNS310 - RNS315 - RNS 510
MULTIVAN	From 2010	RCD310 - RCD315 - RCD510 - RNS310 - RNS315 - RNS 510
NEW BEETLE	From 2012	RCD310 - RCD315 - RCD510 - RNS310 - RNS315 - RNS 510
AMAROK	From 2013	RCD310 - RCD315 - RCD510 - RNS310 - RNS315 - RNS 510
GOLF VII	From 2013	MIB ENTRY - MIB STANDARD
SEAT		
ALTEA	From 2011	RCD310 - RCD315 - RNS310 - RNS315
LEON	From 2011 to 2012	RCD310 - RCD315 - RNS310 - RNS315
LEON	From 2013	MEDIA SYSTEM COLOR - MEDIA SYSTEM PLUS MEDIA SYSTEM NAVIGATION
ALHAMBRA	From 2011	RCD310 - RCD315 - RNS310 - RNS315
TOLEDO	From 2015	SEAT MEDIA SYSTEM
SKODA		
FABIA	From 2011	SWING - RNS AMUNDSEN
ROOMSTER	From 2011	SWING - RNS AMUNDSEN
OCTAVIA	From 2011 to 2012	SWING - RNS AMUNDSEN
OCTAVIA	From 2013	BOLERO - BOLERO PLUS - NAVI AMUNDSEN
YETI	From 2011	SWING - RNS AMUNDSEN
SUPERB	From 2011	SWING - RNS AMUNDSEN
AUDI		
A1	From 2014	RADIO MMI
A3	From 2014	RADIO MMI



PARKVIEW CF0006UNPS41

CANBUS MODULE TO VIZUALIZE PDC ON CAR DISPLAY

Laserline EPS4006-D, ES404B, EPS4012, EPS4012-NU - Paser AFREPS4006-D, AFREPS404B, AFR600RAP511.

INSTALLATION MANUAL



FORD

BEFORE STARTING INSTALLATION, PLEASE ENABLE THE PARKING SENSOR FUNCTION ON THE VEHICLE BY USING OFFICAL FORD DISGNOSTIC TOOL.

CONNECTIONS

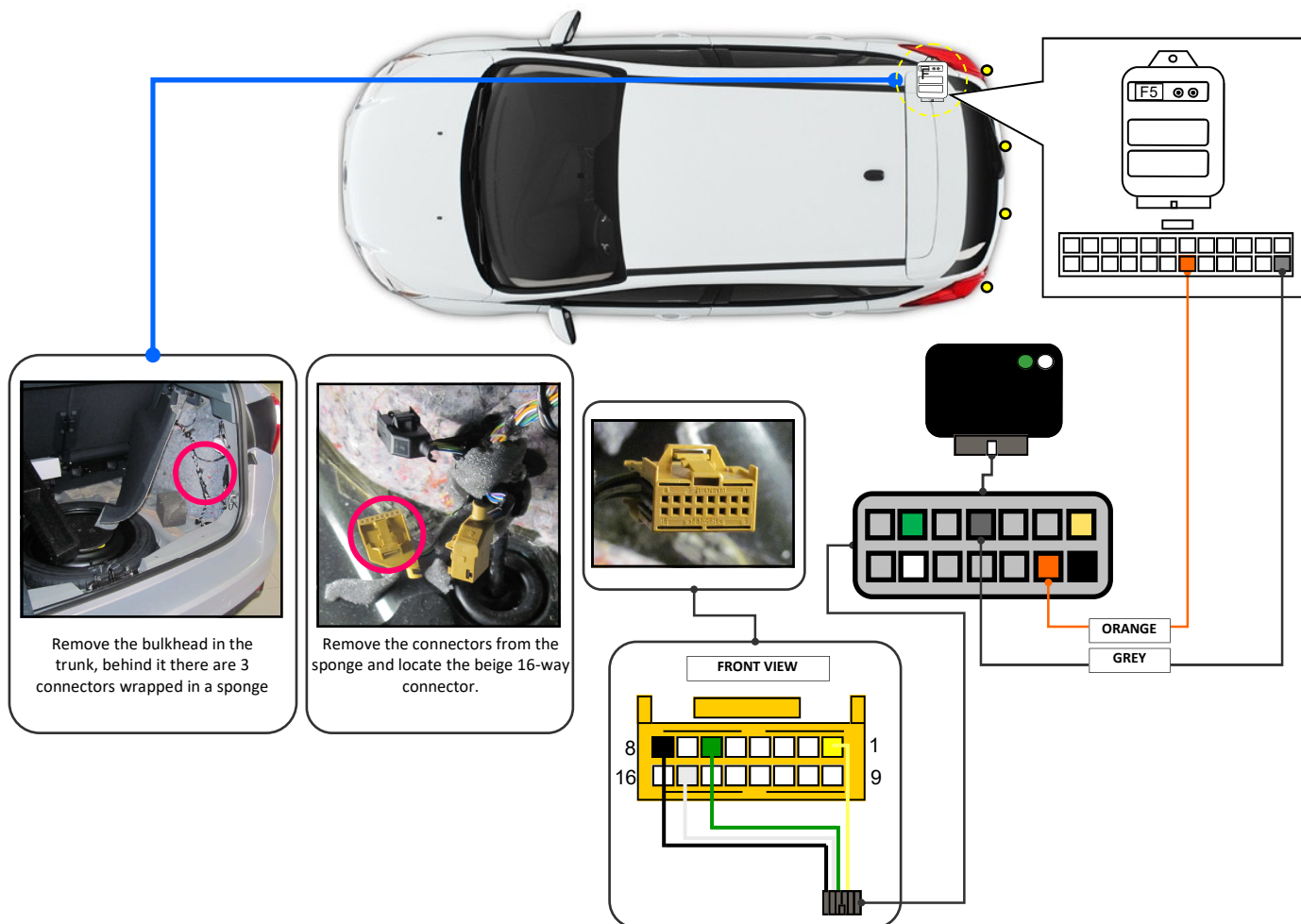

The harness supplied with PARKVIEW is split in 2 sections, the first is composed by 4 wires to connect on the boot of the vehicle. On the OEM 16 ways connector found it must to connect:

YELLOW to the +12vdc positive wire position 1
BLACK to the GND negative wire position 8
GREEN to the CAN H position 6
WHITE to the CAN L position 15

Then connect the terminals ORANGE and GREY in the connector of the parking sensors as above described.

Do not connect the BUZZER of the parking sensors, original sound is maintained. To power the parking sensors please connect it to the reverse lamp.

Once the connection are done the system is immediately ready to work, each time the canbus line will wake up the LED of PARKVIEW will light GREEN to indicate the correct behaviour of the module. Then by inserting the reverse parking sensors will activate, consequently PARKVIEW will activate the visualizing on the OEM radio. With some radio MUTE is managed directly by the radio. By removing the back gear the visualizing will be interrupted.

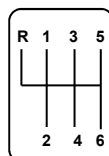
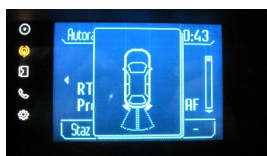
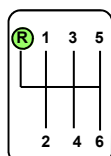

By switching on the parking sensors, Parkview led will generate some red/green flashes confirming the right working.



PARKVIEW CF0006UNPS41

CANBUS MODULE TO VIZUALIZE PDC ON CAR DISPLAY

Laserline EPS4006-D, ES404B, EPS4012, EPS4012-NU - Paser AFREPS4006-D, AFREPS404B, AFR600RAP511.

INSTALLATION MANUAL



ALTERNATIVE CONNECTION

In some cases the OEM connector located in the trunk it is not present.

Where the vehicle is not provided with this connector, please follow the instructions below.

Passenger side: please remove the gloves box so you can find the white multi poles connector shown below.

Identified the connector, please manage the connection instructions described below.

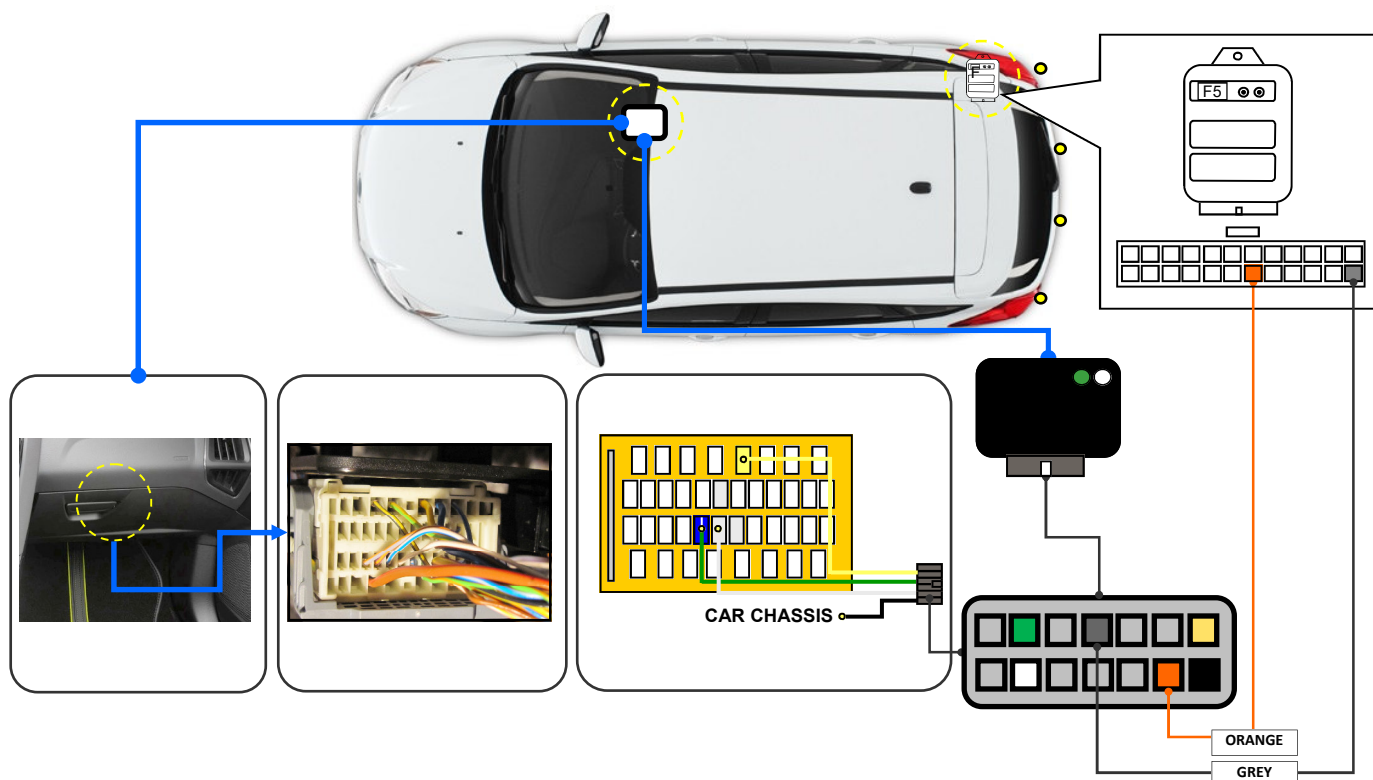

Connect:

GREEN wire of the module to the BLUE / WHITE (CAN H) car connector

WHITE wire of the module to the WHITE (CAN L) of the car connector

BLACK wire of the module to the car chassis (GND)

YELLOW wire of the module to the YELLOW (IGNITION) of the car connector

Do not connect the BUZZER of the parking sensors, original sound is maintained. To power the parking sensors please connect it to the reverse lamp.

SYSTEM WORKS WITH THE IGNITION ON.

SYSTEM STARTS TO WORK BY INSERTING THE REVERSE AND IT SWITCHES OFF BY REMOVING THE REVERSE.

CAR	YEAR	RADIO COMPATIBLE
FORD		
C-MAX	from 2011	OEM
GRAND C-MAX	from 2011	OEM
NEW FOCUS	from 2011	OEM
KUGA	from 2013	OEM



PARKVIEW CF0006UNPS41

CANBUS MODULE TO VIZUALIZE PDC ON CAR DISPLAY

Laserline EPS4006-D, ES404B, EPS4012, EPS4012-NU - Paser AFREPS4006-D, AFREPS404B, AFR600RAP511.

INSTALLATION MANUAL



FIAT

BEFORE STARTING INSTALLATION, PLEASE ENABLE THE PARKING SENSOR FUNCTION ON THE VEHICLE BY USING OFFICAL FIAT DISGNOSTIC TOOL.

CONNECTIONS

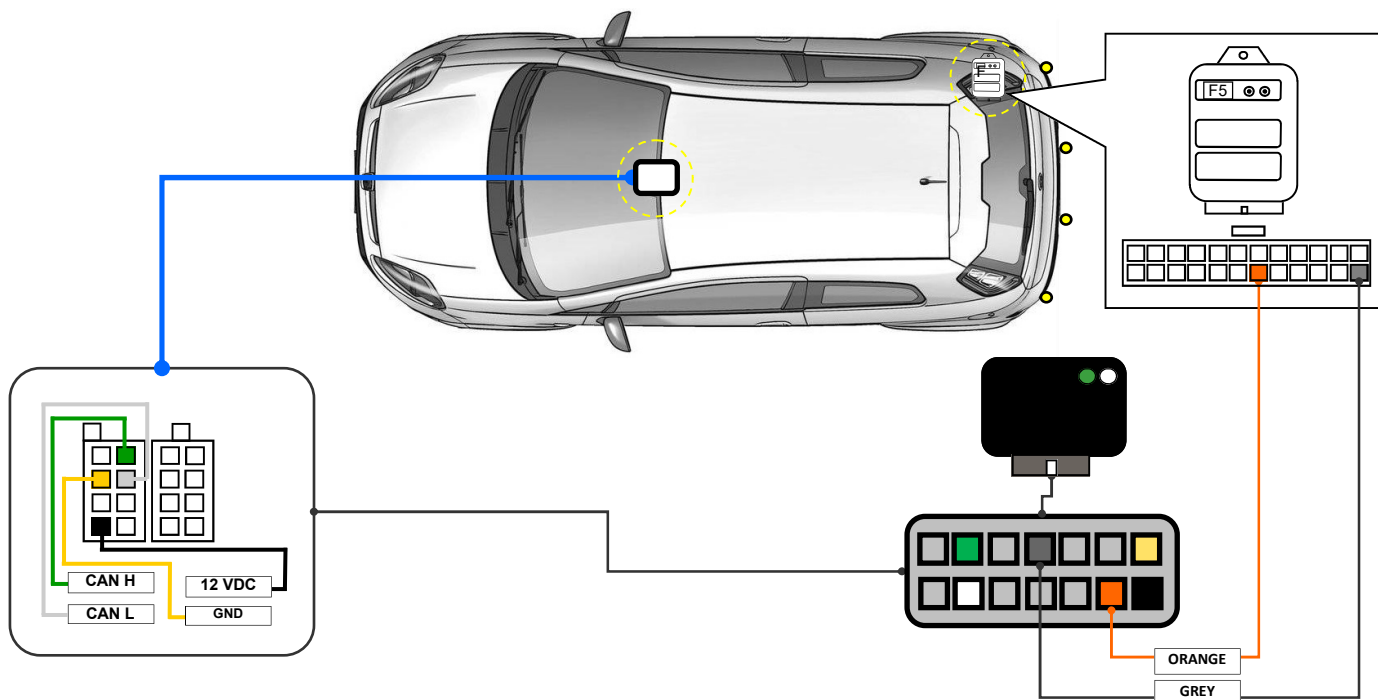

The harness supplied with PARKVIEW is split in 2 sections, the first is composed by 4 wires to connect on the radio compartment of the vehicle. Connect:

YELLOW to the +12vdc positive
BLACK to the GND negative
GREEN to the CAN H
WHITE to the CAN L

Then connect the terminals ORANGE and GREY in the connector of the parking sensors as above described.

Do not connect the BUZZER of the parking sensors, original sound is maintained. To power the parking sensors please connect it to the reverse lamp.

Once the connection are done the system is immediately ready to work, each time the canbus line will wake up the LED of PARKVIEW will light GREEN to indicate the correct behaviour of the module. Then by inserting the reverse parking sensors will activate, consequently PARKVIEW will activate the visualizing on the OEM radio. With some radio MUTE is managed directly by the radio. By removing the back gear the visualizing will be interrupted.

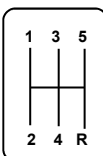
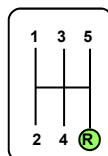

CAR	YEAR	RADIO COMPATIBLE
FIAT		
GRANDE PUNTO	from 2008	OEM
ALFA ROMEO		
MITO	from 2008	OEM

By switching on the parking sensors, Parkview led will generate some red/green flashes confirming the right working.



PARKVIEW CF0006UNPS41

CANBUS MODULE TO VIZUALIZE PDC ON CAR DISPLAY

Laserline EPS4006-D, ES404B, EPS4012, EPS4012-NU - Paser AFREPS4006-D, AFREPS404B, AFR600RAP511.

INSTALLATION MANUAL



PEUGEOT

BEFORE STARTING INSTALLATION, PLEASE ENABLE THE PARKING SENSOR FUNCTION ON THE VEHICLE BY USING OFFICAL PEUGEOT DISGNOSTIC TOOL.

CONNECTIONS

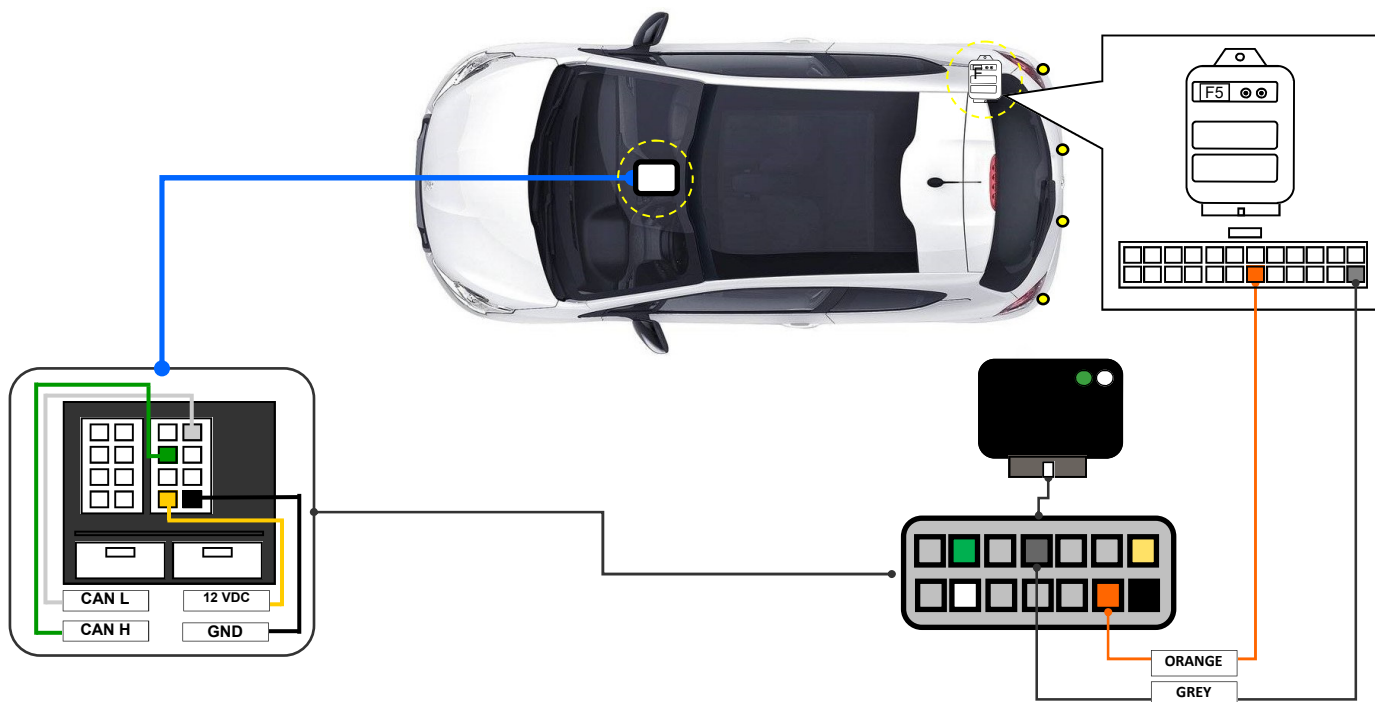

The harness supplied with PARKVIEW is split in 2 sections, the first is composed by 4 wires to connect on the radio compartment of the vehicle. Connect:

YELLOW to the +12vdc positive
BLACK to the GND negative
GREEN to the CAN H
WHITE to the CAN L

Then connect the terminals ORANGE and GREY in the connector of the parking sensors as above described.

Do not connect the BUZZER of the parking sensors, original sound is maintained. To power the parking sensors please connect it to the reverse lamp.

Once the connection are done the system is immediately ready to work, each time the canbus line will wake up the LED of PARKVIEW will light GREEN to indicate the correct behaviour of the module. Then by inserting the reverse parking sensors will activate, consequently PARKVIEW will activate the visualizing on the OEM radio. With some radio MUTE is managed directly by the radio. By removing the back gear the visualizing will be interrupted.

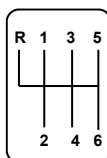
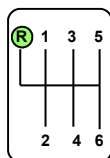

CAR	YEAR	RADIO COMPATIBLE
PEUGEOT		
508	from 2012	OEM
208	from 2012	OEM
3008	from 2013	OEM

By switching on the parking sensors, Parkview led will generate some red/green flashes confirming the right working.



PARKVIEW CF0006UNPS41

CANBUS MODULE TO VIZUALIZE PDC ON CAR DISPLAY

Laserline EPS4006-D, ES404B, EPS4012, EPS4012-NU - Paser AFREPS4006-D, AFREPS404B, AFR600RAP511.

INSTALLATION MANUAL



HONDA

**HONDA VEHICLES COMPATIBLE DON'T NEED ANY PDC ACTIVATION.
VEHICLE SET THE FUNCTION AUTOMATICALLY. IT'S NOT POSSIBLE TO RESET THE SETTING**

CONNECTIONS

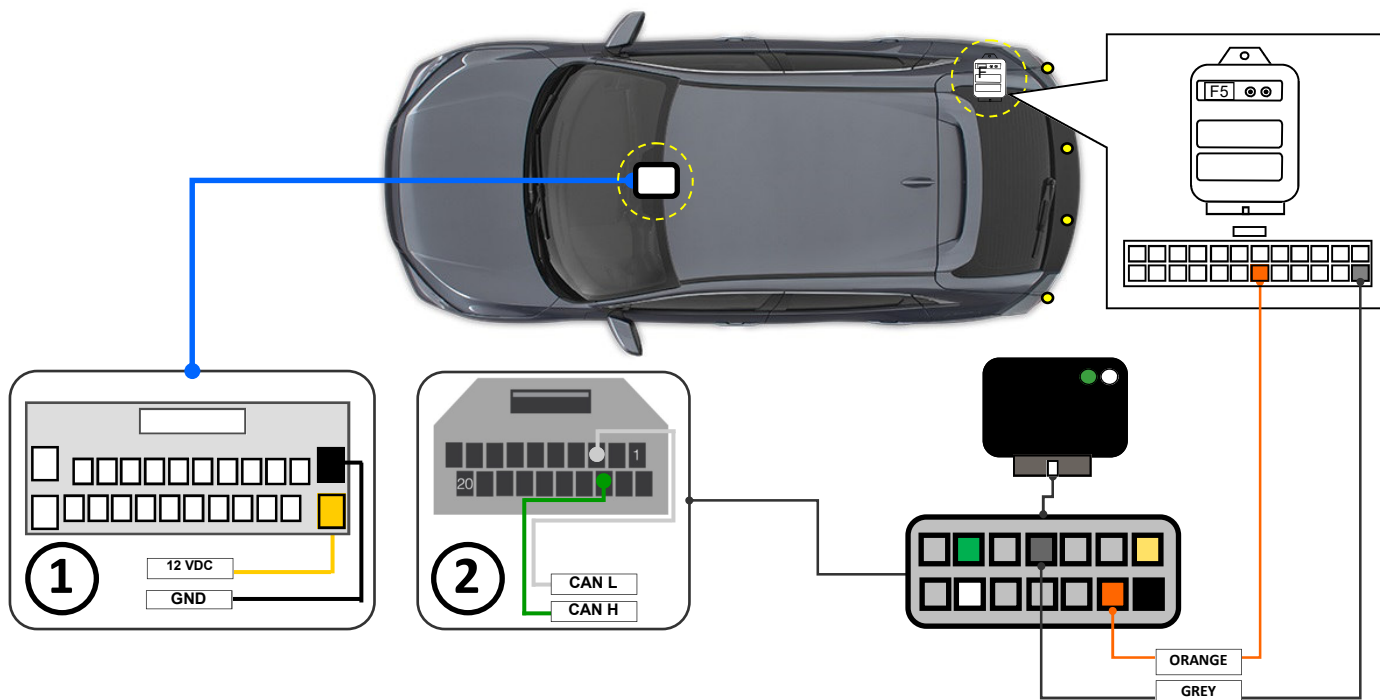

The harness supplied with PARKVIEW is split in 2 sections, the first is composed by 4 wires to connect to connectors 1 and 2 on the radio compartment of the vehicle. Connect:

Connector 1:

YELLOW to the +12vdc positive

BLACK to the GND negative

Connector 2:

GREEN to the CAN H

WHITE to the CAN L

Then connect the terminals ORANGE and GREY in the connector of the parking sensors as above described.

Do not connect the BUZZER of the parking sensors, original sound is maintained. To power the parking sensors please connect it to the reverse lamp.

Once the connection are done the system is immediately ready to work, each time the canbus line will wake up the LED of PARKVIEW will light GREEN to indicate the correct behaviour of the module. Then by inserting the reverse parking sensors will activate, when an obstacle is detected PARKVIEW will activate the visualizing on the OEM radio. With some radio MUTE is managed directly by the radio. By removing the back gear the visualizing will be interrupted.

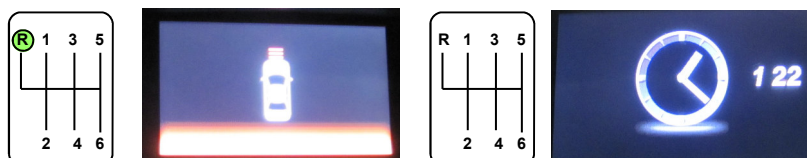

PDC OPERATIONS ARE DISPLAYED ONLY WHEN THE SYSTEM DETECTS AN OBSTACLE

CAR	YEAR	RADIO COMPATIBLE
HONDA		
CR-V	from 2013	OEM
CIVIC	from 2013	OEM

By switching on the parking sensors, Parkview led will generate some red/green flashes confirming the right working.

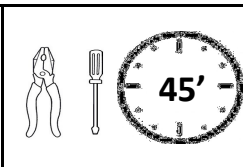
	<p align="center">PARKVIEW CF0006UNPS41</p> <p align="center">CANBUS MODULE TO VIZUALIZE PDC ON CAR DISPLAY</p> <p align="center">Laserline EPS4006-D, ES404B, EPS4012, EPS4012-NU - Paser AFREPS4006-D, AFREPS404B, AFR600RAP511.</p> <p align="center">INSTALLATION MANUAL</p>	
---	---	--

ATTENTION

POWER THE PARKING SENSOR CONTROL UNIT FROM THE REVERSE LAMP, FOLLOW THE PDC INSTRUCTION MANUAL.

SYSTEM WORKS WITH THE IGNITION ON.

SYSTEM STARTS TO WORK BY INSERTING THE REVERSE AND IT SWITCHES OFF BY REMOVING THE REVERSE.

IF YOU NEED TO INSTALL THE SAME UNIT IN A NEW CAR, IT IS NECESSARY TO RESET THE MODULE.

RESET:

1. WITH THE UNIT POWERED, PRESS AND KEEP PRESSED THE UNIT BUTTON TILL THE LED SWITCHES OFF.
2. WITH THE LED SWITCHED OFF, RELEASE THE BUTTON: THE RESET IS DONE.

TROUBLESHOOTING**Parking Sensor UNIT**

PROBLEM	CAUSE	SOLUTION
The system doesn't work when the back gear is inserted.	Wrong connection of the power wires	Power the parking sensors by the reverse gear light
	Wrong connection of the plugs	Verify the connection of the connectors of the parking system
The system detects always the obstacle	The system detects the ground	Verify that the sensors caps are installed horizontally respect the ground.
	Caps sensors are varnished incorrectly	Verify that the caps varnish layer is not too thick. In this case the sensors can detect it as an obstacle.
	The test is made in closed space	Please make the test of the system in an open space and not into a close room.
The sound of the buzzer is not available	BUZZER not connected (only for VW cars)	Check the connection between Buzzer and parking sensors Unit
	Wrong connections of the caps sensors	Please control the caps sensors connection

PARKVIEW

PROBLEM	CAUSE	SOLUTION
The unit doesn't manage any function and the LED is OFF.	Wrong connection of the power wires	Verify the power connections
The unit is right connected but it doesn't manage any function and the LED is OFF.	Wrong connection of the CANBUS wires	Verify the CANBUS connections
The unit is right connected and the LED blinks RED quickly.	CANBUS protocol unknown or upgraded by the car manufacturer	The unit is not able to synchronize the CANBUS protocol; please contact the distributor
The unit is right connected and the LED blinks RED irregularly.	Wrong connection of the CANBUS wires	Verify the CANBUS connections
The unit is right connected and the LED switches on RED.	CANBUS protocol unknown or upgraded by the car manufacturer	The unit is not able to synchronize the CANBUS protocol; please contact the distributor

TECHNICAL CHARACTERISTICS

POWER	10/16 VDC
SLEEP MODE ABSORPTION	<1 mA
WORKING MODE ABSORPTION	100 mA

WARRANTY

THIS PRODUCT IS GUARANTEED FOR 2 YEARS FOR ANY MANUFACTURING DEFECTS. FISCAL DOCUMENT SERVES AS GUARANTEE VALIDITY.

The information in this guide are purely for information purposes, therefore, are subject to change without notice. At the time of publication the information is correct and reliable. However Paser can not be held responsible for any consequences resulting from errors or omissions in this manual. Paser reserves the right to improve / change the product or manual without obligation to notify users.

Technical support:: +39 0141 - 947676