

	<b>TESLA MODEL 3</b> 	<b>2020&gt;</b> <b>PROTOCOLLO CANBUS 2C</b>  <b>2020&gt;</b> <b>2W CANBUS PROTOCOL</b>
			



**ATTENZIONE!!!**  
**PRIMA DI SCOLLEGARE IL CONNETTORE E' TASSATIVO CHE IL VEICOLO SIA COMPLETAMENTE IN SLEEP MODE. SI CONSIGLIA DI DISABILITARE LA FUNZIONE: ACCESSO MOBILE.**



**ATTENTION!!!**  
**BEFORE DISCONNECTING THE CONNECTOR, THE VEHICLE MUST BE COMPLETELY IN SLEEP MODE. IT IS RECOMMENDED TO DISABLE THE FUNCTION: MOBILE ACCESS.**

#### POSIZIONE CONNETTORE: DIETRO TUNNEL CENTRALE - CONNECTOR LOCATION: BACK CENTRAL TUNNEL

INDIVIDUARE IL CONNETTORE COME SOTTO DESCRITTO.  
 PLEASE FIND THE CONNECTOR HOW BELOW DESCRIBED.

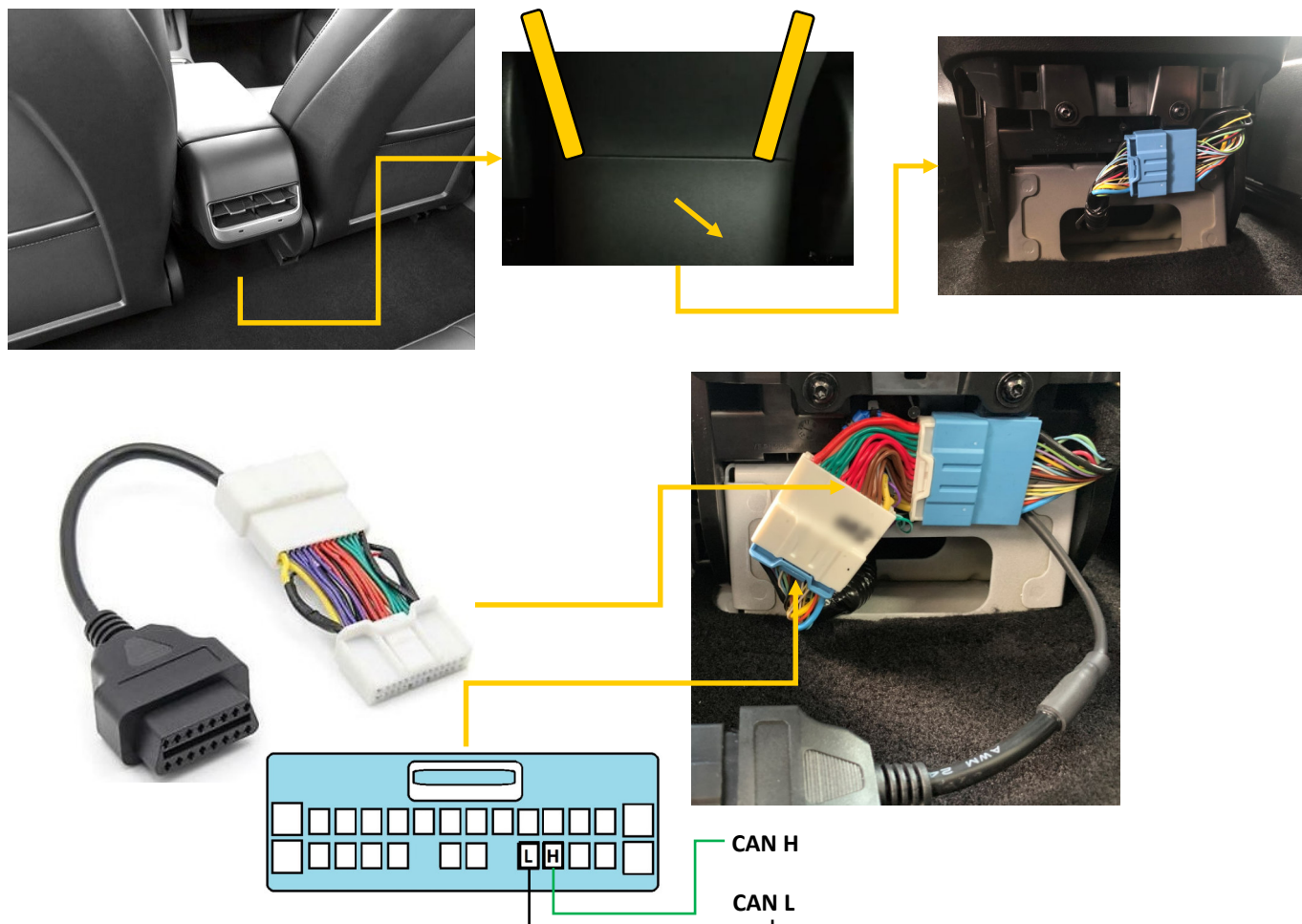

#### PRODOTTI SUGGERITI - SUGGESTED PRODUCTS

SLIMKEY