



SMART PARK CF0026UNPS51

CANBUS MODULE TO DISPLAY FRONT / REAR PARKING SENSORS ON OEM RADIO SCREEN.
Vodafone R294 - R394 - AMR394/F

INSTALLATION MANUAL



DESCRIPTION

SMARTPARK is an electronic module, easy to install, that allows you to integrate professionally aftermarket parking sensors on the Volkswagen Group vehicles equipped with the OEM radio.

The device allows to display on the OEM radio of Volkswagen group the signalling of the parking sensors as it happens for the OEM parking sensors.

VOLKSWAGEN

CAUTION

FOR THE CORRECT OPERATION OF THE SYSTEM, THE VEHICLE MUST BE ENABLED AT THE DISPLAY, THROUGH THE OFFICIAL DIAGNOSTIC DEVICE OF VOLKSWAGEN.

CONNECTIONS

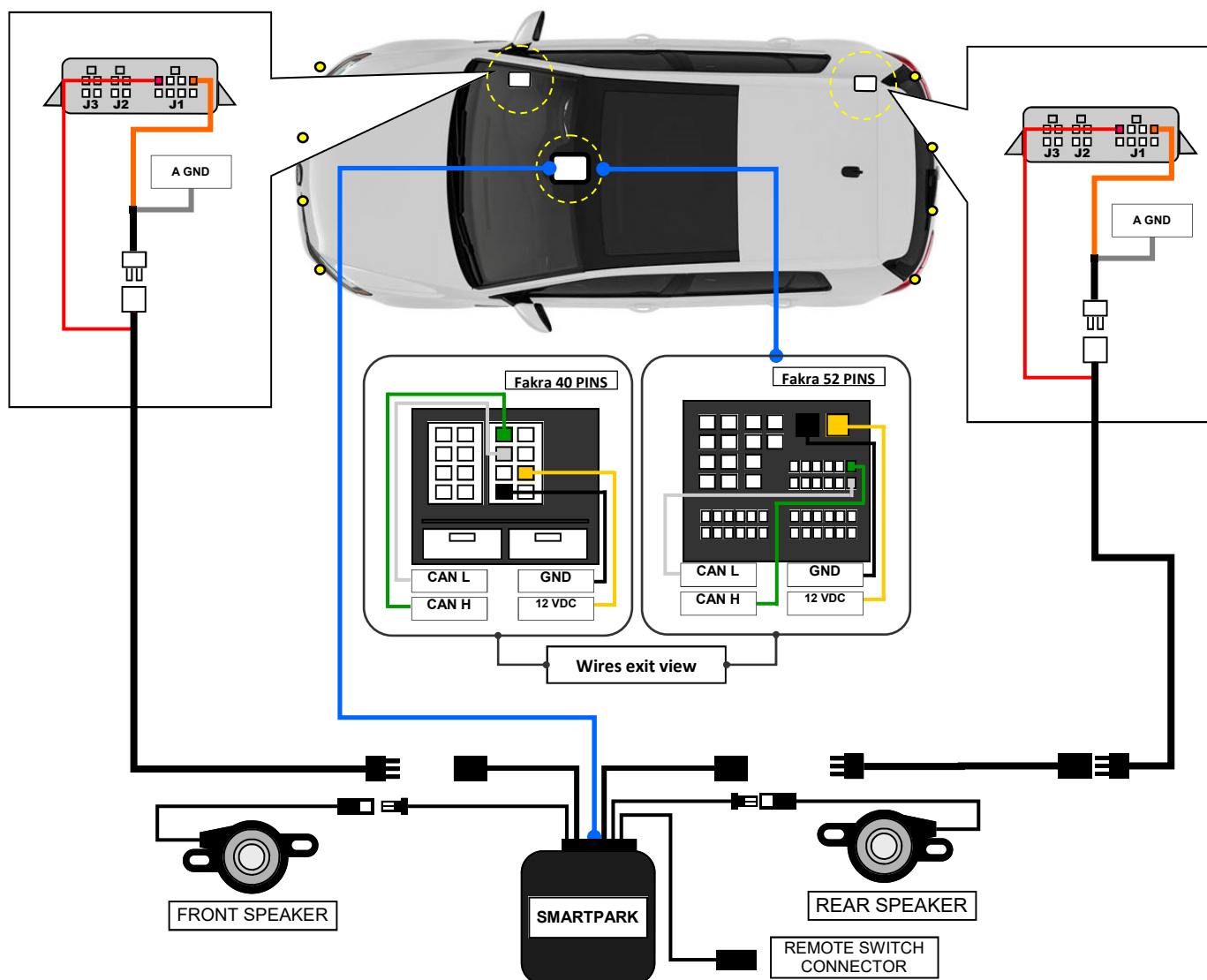

ATTENTION: PLEASE PLACE THE PARKING SENSOR CONTROL UNITS ON THE RIGHT SIDE OF THE VEHICLE

SYSTEM WORKS WITH IGNITION ON.

THE SYSTEM ACTIVATES BY INSERTING THE REVERSE AND DEACTIVATES AFTER 10 SECONDS BY REMOVING THE REVERSE OR EXCEEDING 10 KM / H.

ON / OFF MANUAL OF THE PARKING SENSORS

If the vehicle is equipped with steering wheel controls, by pressing OK button for 3 seconds on the steering wheel controls, sensors will turn on / off. This operation is manageable if the vehicle is driving below 10 km / h

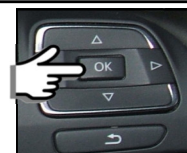

	<p align="center">SMART PARK CF0026UNPS51</p> <p align="center">CANBUS MODULE TO DISPLAY FRONT / REAR PARKING SENSORS ON OEM RADIO SCREEN. Vodafone R294 - R394 - AMR394/F</p> <p align="center">INSTALLATION MANUAL</p>	 
---	--	---

ALTERNATIVE CONNECTION DRIVER SIDE LOCATION

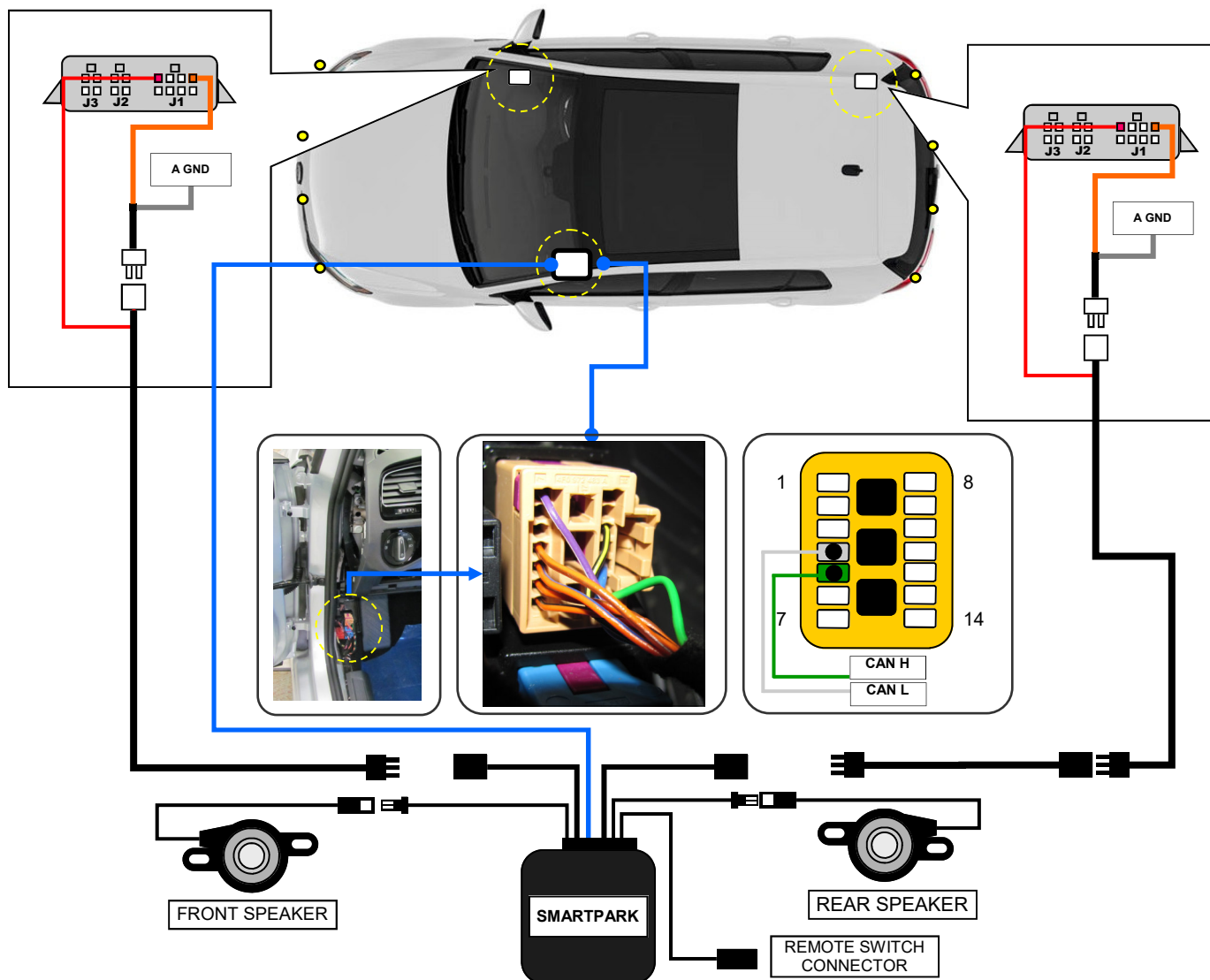

ATTENTION: PLEASE PLACE THE PARKING SENSOR CONTROL UNITS ON THE RIGHT SIDE OF THE VEHICLE

SYSTEM WORKS WITH IGNITION ON.

THE SYSTEM ACTIVATES BY INSERTING THE REVERSE AND DEACTIVATES AFTER 10 SECONDS BY REMOVING THE REVERSE OR EXCEEDING 10 KM / H.

	<p align="center">SMART PARK CF0026UNPS51</p> <p align="center">CANBUS MODULE TO DISPLAY FRONT / REAR PARKING SENSORS ON OEM RADIO SCREEN. Vodafone R294 - R394 - AMR394/F</p> <p align="center">INSTALLATION MANUAL</p>	 
---	--	---

AUDI A1 CONNECTIONS

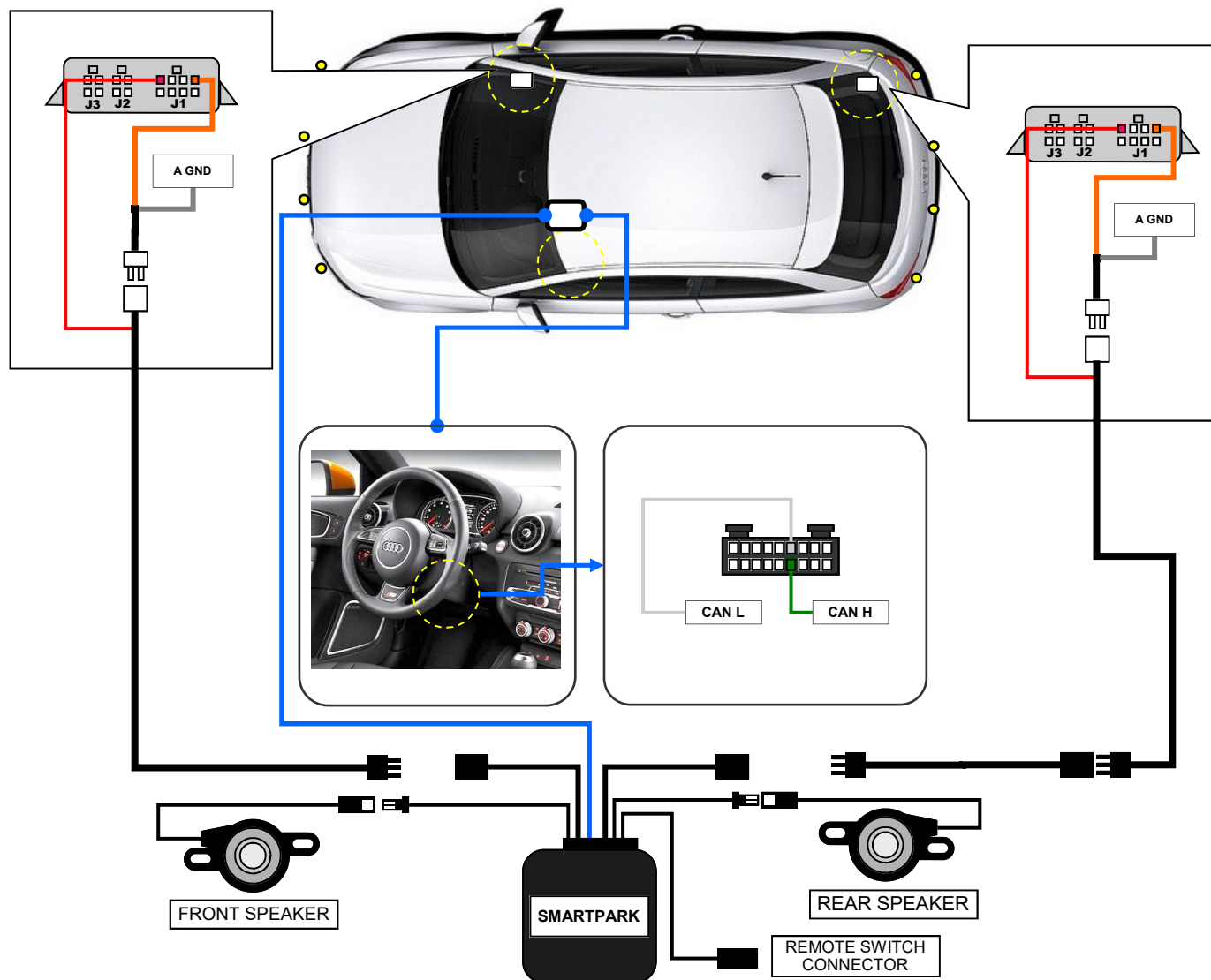

ATTENTION: PLEASE PLACE THE PARKING SENSOR CONTROL UNITS ON THE RIGHT SIDE OF THE VEHICLE

SYSTEM WORKS WITH IGNITION ON.
THE SYSTEM ACTIVATES BY INSERTING THE REVERSE AND DEACTIVATES AFTER 10 SECONDS BY REMOVING THE REVERSE OR EXCEEDING 10 KM / H.

	<p align="center">SMART PARK CF0026UNPS51</p> <p align="center">CANBUS MODULE TO DISPLAY FRONT / REAR PARKING SENSORS ON OEM RADIO SCREEN. Vodafone R294 - R394 - AMR394/F</p> <p align="center">INSTALLATION MANUAL</p>	 
---	--	--

DESCRIPTION

SMARTPARK is an electronic module, easy to install, that allows you to integrate professionally aftermarket parking sensors on the Peugeot Group vehicles equipped with the OEM radio.

The device allows to display on the OEM radio of Peugeot group the signalling of the parking sensors as it happens for the OEM parking sensors.

PEUGEOT**CAUTION**

FOR THE CORRECT OPERATION OF THE SYSTEM, THE VEHICLE MUST BE ENABLED AT THE DISPLAY, THROUGH THE OFFICIAL DIAGNOSTIC DEVICE OF PEUGEOT.

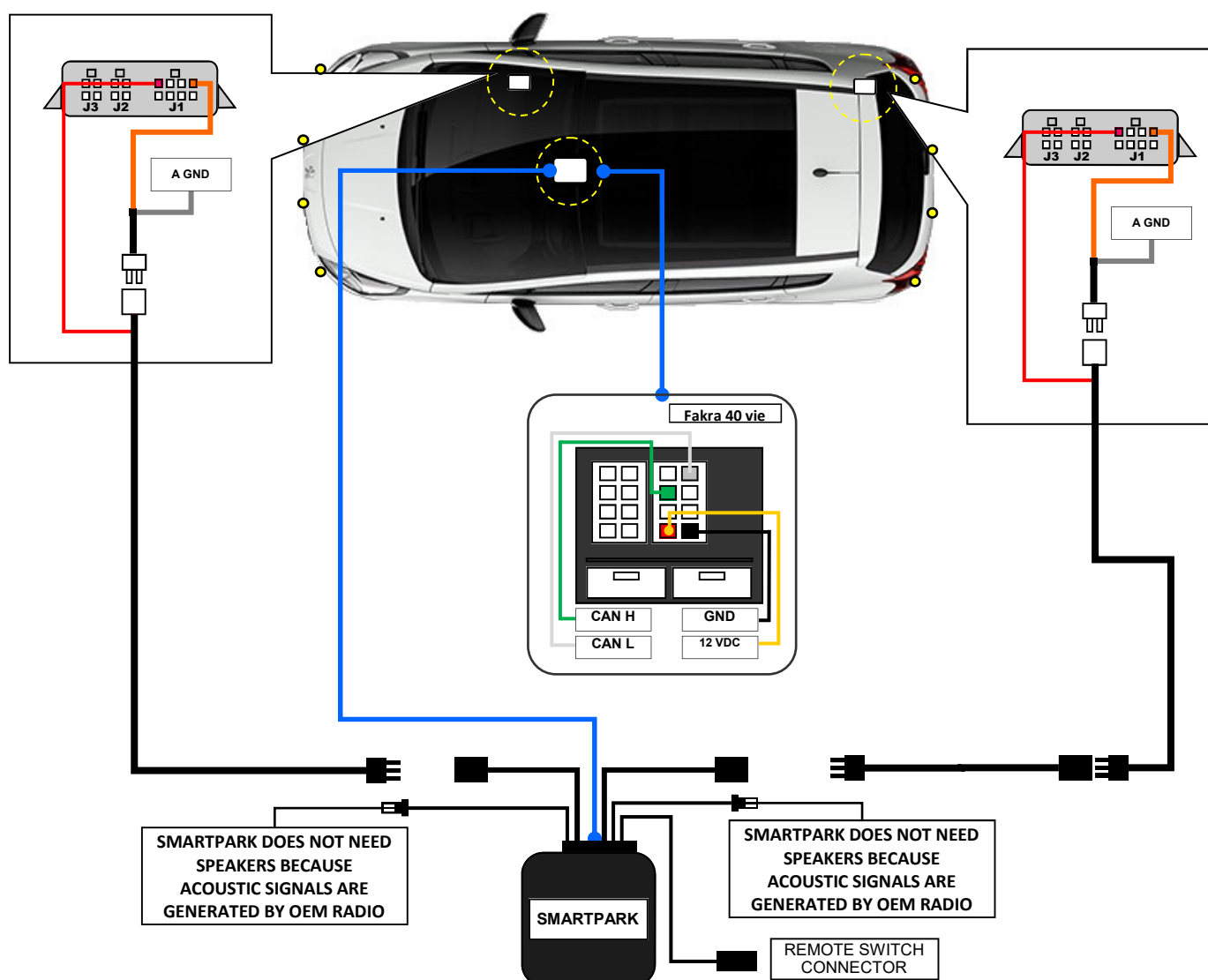
CONNECTIONS

ATTENTION: PLEASE PLACE THE PARKING SENSOR CONTROL UNITS ON THE RIGHT SIDE OF THE VEHICLE

SYSTEM WORKS WITH IGNITION ON.

THE SYSTEM ACTIVATES BY INSERTING THE REVERSE AND DEACTIVATES AFTER 10 SECONDS BY REMOVING THE REVERSE OR EXCEEDING 10 KM / H.

	<p align="center">SMART PARK CF0026UNPS51</p> <p align="center">CANBUS MODULE TO DISPLAY FRONT / REAR PARKING SENSORS ON OEM RADIO SCREEN. Vodafone R294 - R394 - AMR394/F</p> <p align="center">INSTALLATION MANUAL</p>	
---	--	---

ATTENTION

SYSTEM WORKS WITH THE IGNITION ON.

SYSTEM STARTS TO WORK BY INSERTING THE REVERSE AND IT SWITCHES OFF AFTER 10 SECONDS BY REMOVING THE REVERSE OR EXCEEDING 10 KM / H.

IF YOU NEED TO INSTALL THE SAME UNIT IN A NEW CAR, IT IS NECESSARY TO RESET THE MODULE.

RESET:

1. WITH THE UNIT POWERED, PRESS AND KEEP PRESSED THE UNIT BUTTON TILL THE LED SWITCHES OFF.
2. WITH THE LED SWITCHED OFF, RELEASE THE BUTTON: THE RESET IS DONE.

TROUBLESHOOTING**Parking Sensor UNIT**

PROBLEM	CAUSE	SOLUTION
The system doesn't work when the back gear is inserted.	Wrong connection of the power wires	Power the parking sensors by the reverse gear light
	Wrong connection of the plugs	Verify the connection of the connectors of the parking system
The system detects always the obstacle	The system detects the ground	Verify that the sensors caps are installed horizontally respect the ground.
	Caps sensors are varnished incorrectly	Verify that the caps varnish layer is not too thick. In this case the sensors can detect it as an obstacle.
	The test is made in closed space	Please make the test of the system in an open space and not into a close room.
The sound of the buzzer is not available	BUZZER not connected (only for VW cars)	Check the connection between Buzzer and parking sensors Unit
	Wrong connections of the caps sensors	Please control the caps sensors connection

SMARTPARK

PROBLEM	CAUSE	SOLUTION
The unit doesn't manage any function and the LED is OFF.	Wrong connection of the power wires	Verify the power connections
The unit is right connected but it doesn't manage any function and the LED is OFF.	Wrong connection of the CANBUS wires	Verify the CANBUS connections
The unit is right connected and the LED blinks RED quickly.	CANBUS protocol unknown or upgraded by the car manufacturer	The unit is not able to synchronize the CANBUS protocol; please contact the distributor
The unit is right connected and the LED blinks RED irregularly.	Wrong connection of the CANBUS wires	Verify the CANBUS connections
The unit is right connected and the LED switches on RED.	CANBUS protocol unknown or upgraded by the car manufacturer	The unit is not able to synchronize the CANBUS protocol; please contact the distributor

TECHNICAL CHARACTERISTICS

POWER	10/16 VDC
SLEEP MODE ABSORPTION	<1 mA
WORKING MODE ABSORPTION	100 mA

WARRANTY

THIS PRODUCT IS GUARANTEED FOR 2 YEARS FOR ANY MANUFACTURING DEFECTS. FISCAL DOCUMENT SERVES AS GUARANTEE VALIDITY.

The information in this guide are purely for information purposes, therefore, are subject to change without notice. At the time of publication the information is correct and reliable. However Paser can not be held responsible for any consequences resulting from errors or omissions in this manual. Paser reserves the right to improve / change the product or manual without obligation to notify users.