



## MENU SETTING DATE HOUR

**UNICAN** allows you to set some functions usually managed through the OEM head unit .

By making a simple and intuitive procedure it's possible to set functions such as:

- Hour
- Date
- Language
- General Setting



### ATTENTION

**MENU AVAILABILITY IS TEMPORIZED, IF ANY BUTTON IS PRESSED WITHIN 30 SECONDS, THE SYSTEM EXIT AUTOMATICALLY. TO EXIT THE SETTING FUNCTION ONCE ENDED THE CHANGES, PLEASE TURN OFF AND REMOVE THE IGNITION KEY.**



### PSA MENU SETTING

To enter the menu setting, just turn on the ignition, switch OFF the radio, then press twice the sequence of buttons MODE and SEEK >>. Once done this operation the car display will visualize the voice MENU.



Now each time we press SEEK >> button or wheel forward, we will scroll the Main Menu.

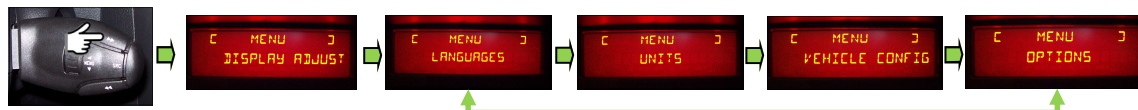

To select one of the Sub Menu press SRC button. In the example below we visualize DISPLAY ADJUST in which we can modify hours and date.

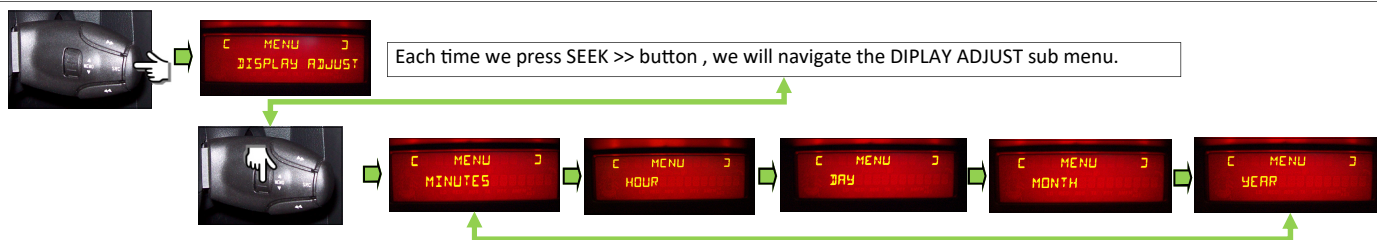

To modify one of the voices, select it by using SEEK >> button. In the example below we visualize HOUR.



The menu selection logic is the same for all sub menu voices. Below a simplified description.

#### Enter menu

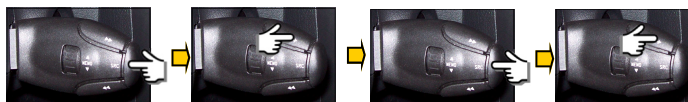

#### Scroll Main Menu



#### Scroll Sub Menu



#### Confirm selection



Menu setting it's temporized, if any button is pressed within 30 seconds the system exit automatically. To re-activate the menu just press volume +



**Once finished the settings, please switch OFF ignition and remove the key.**



## MENU SETTING DATE HOUR



### ATTENTION

MENU AVAILABILITY IS TEMPORIZED, IF ANY BUTTON IS PRESSED WITHIN 30 SECONDS, THE SYSTEM EXIT AUTOMATICALLY. TO EXIT THE SETTING FUNCTION ONCE ENDED THE CHANGES, PLEASE TURN OFF AND REMOVE THE IGNITION KEY.



### MENU OPEL SETTING

To enter the menu setting, please turn on the ignition, switch OFF the radio, then press twice the sequence of buttons <> and MODE . Once done this operation the car display will visualize the voice SYSTEM.

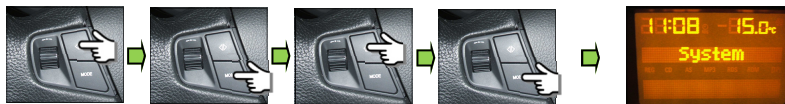

Now by pressing <> button will be displayed the first MENU voice CLOCK SYNC OFF.

Jump this function by pressing <> once again in order to display the MENU voice HH ↑ MM ↓ that allows to set the HOURS.



In the example it's 11 o'clock.

To increase press SEEK ▲ button. To decrease press SEEK ▼ button.



Now by pressing <> button will be displayed the second voice of the MENU HH ↑ MM ↓ that allows to set the MINUTES.

In the example the minutes are 08.

If we want to increase press SEEK ▲ button.

If we want to decrease press SEEK ▼ button.

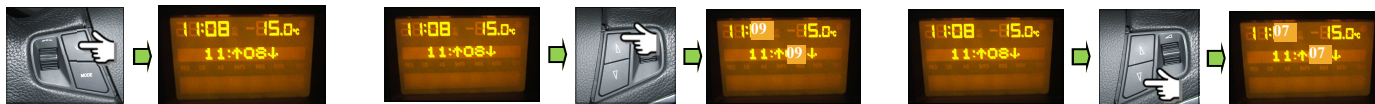

Now by pressing <> button will be displayed the voice of the MENU DATE that allows to set the DD ↑ MM ↓ YEAR.

In the example the day is 24th.

If we want to increase press SEEK ▲ button.

If we want to decrease press SEEK ▼ button.

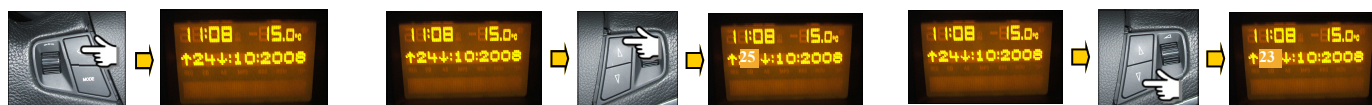

Once the DAY setting is done by pressing the <> button, the DD MM ↑ YEAR ↓ MENU is shown, which is the MONTH setting, pressing the <> button again will show DD ↑ MM ↓ YEAR which is the YEAR setting.

The configuration is always managed with the SEEK button ▲ to increase or the SEEK button ▼ to decrease.

Other MENU voices are available after TIME and DATE:

IGN LOGIC OFF

LANGUAGE

To change them, just press the SEEK ▲ or SEEK ▼ buttons.

**Once the setting is done wait the automatic exit from the MENU, then switch OFF the ignition and extract the car key.**



## MENU SETTING DATE HOUR



### ATTENTION

MENU AVAILABILITY IS TEMPORIZED, IF ANY BUTTON IS PRESSED WITHIN 30 SECONDS, THE SYSTEM EXIT AUTOMATICALLY. TO EXIT THE SETTING FUNCTION ONCE ENDED THE CHANGES, PLEASE TURN OFF AND REMOVE THE IGNITION KEY.



### MENU FIAT SETTING

To enter the settings menu you have simply turn the ignition on, consequently press twice the buttons sequence <MUTE - PHONE ANSWER>. Once done the sequence, the display will show the year instead of the time.



Volume buttons allow YEAR adjustment. In the example is the year 2016. To increase the year you need to press the button V+, to decrease it you need to press V-.



To turn to the HOURS setting, press PHONE ANSWER.

Volume buttons allow HOURS adjustment. In this example is 11:30.

To increase hours you need to press the button V+, to decrease them you need to press V-.



To turn to the MINUTES setting, press PHONE ANSWER. Volume buttons allow MINUTES adjustment. In this example is 11:30.

To increase minutes you need to press the button V+, to decrease them you need to press V-.



To turn to the DAY setting, press PHONE ANSWER.

Volume buttons allow DAY adjustment. In this example the day is SUNDAY.

To increase the month you need to press the button V+, to decrease it you need to press V-.



To turn to the MONTH setting, press PHONE ANSWER.

Volume buttons allow MONTH adjustment. In this example the month is February.

To increase the month you need to press the button V+, to decrease it you need to press V-.



To turn to the DATE setting, press PHONE ANSWER. Volume buttons allow DATE adjustment. In this example the DATE is 27.

To increase the day you need to press the button V+, to decrease it you need to press V-.



To exit from the MENU SETTING turn off the ignition and remove the key .



## MENU SETTING DATE HOUR