

WARRANTY CONDITIONS

THIS PRODUCT HAS A TWO-YEAR GUARANTEE FOR ANY KIND OF MANUFACTURING DEFECT.
THE FISCAL DOCUMENT SERVES AS THE GUARANTEE VALIDITY.

The information in this guide are purely for information purposes, therefore, are subject to change without notice. At the time of publication the information is correct and reliable. However Paser can not be held responsible for any consequences resulting from errors or omissions in this manual. Paser reserves the right to improve / change the product or manual without obligation to notify users.

INSTALLATION MANUAL

UNICAN 1C

1 wire CANBUS Adapter for Steering Wheel Commands and **ALPINE** Autoradios with wired Remote input rev. 7

DESCRIPTION

UNICAN 1C is an **adapter** for steering wheel commands with a **CANBUS** protocol; its compatibility extends to cars listed at page 7 and to the autoradios of the **ALPINE** range having a wired input on the back of the autoradio for the control of the remote.

The module supplies services not only to the steering wheel commands but also to the ignition key, sidelights (only 93), reverse gear (only 93) and odometer.

DESCRIPTION OF CABLING

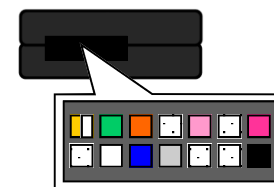

CABLE	FUNCTION
RED	POSITIVE POWER SUPPLY
BLACK	NEGATIVE POWER SUPPLY
GREEN	CAN HIGH
WHITE	CAN LOW / K-BUS
PINK	POSITIVE IGNITION OUTPUT
ORANGE	POSITIVE SIDELIGHTS OUTPUT
GREY	ODOMETRIC SIGNAL
BLUE	POSITIVE REVERSE GEAR OUTPUT
YELLOW/WHITE	NEGATIVE HANDBRAKE OUTPUT
JACK	INSERT THE JACK OF THE UNIT IN THE INPUT OF THE WIRED REMOTE BEHIND THE AUTORADIO



ATTENTION ON THE SAAB 95 IT IS NOT POSSIBLE TO MANAGE THE LIGHT OUTPUT. WE SUGGEST TO CONNECT THE INPUT OF THE RADIO TO TOGETHER WITH THE IGNITION WIRE OF THE MODULE (RED).

SELF-LEARNING AND FUNCTIONS

The selection of the protocol comes through **SELF-RECOGNITION**; on the termination of the connections and after inserting the module to the connector, the unit will carry out the synchronization in about one second, confirmed by **quick red flashes** of the module's LED.

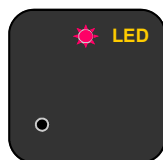

As soon as the synchronization is carried out, the vehicle's protocol will be selected; this operation will be confirmed by the lighting up of the **FIXED GREEN LIGHT** of the module's Led. The unit is ready to work.



JUMPERS

1 2 3
○ ○ ○ J1
○ ○ ○ J2
○ ○ ○ J3
○ ○ ○ J4
○ ○ ○ J5

	1 - 2	2 - 3
J1		
J2	BRAKE GND OUTPUT	POSITIVE BRAKE OUTPUT
J3	REVERSE GND OUTPUT	POSITIVE REVERSE OUTPUT
J4		
J5	K-BUS HANDLING	CAN-BUS HANDLING

COMPATIBILY

AUTO	YEAR
SAAB	
93	From 2006
95	From 2006
OPEL	
CORSA D	From 2009

TROUBLESHOOTING

- The unit doesn't carry out any function and the LED is off.
- Verify the connections of the power supply.
- The correctly powered unit doesn't carry out any function and the LED is off.
- Verify the CANBUS connections.
- The unit is connected correctly and the RED LED flashes quickly.
- The unit hasn't been able to synchronize with the CANBUS, contact Paser.
- The unit is connected correctly and the RED LED flashes in an irregular way.
- Verify the CANBUS connections.
- The unit is connected correctly and the RED LED is lit up.
- The unit has carried out the synchronization with the CANBUS but hasn't been able to identify the vehicle, contact Paser.
- The unit is connected correctly but isn't capable of handling the K-BUS protocol.
- Verify that the J5 jumper is inserted between pins 1 and 2.
- The unit is connected correctly, the GREEN LED is lit up but doesn't control the radio.
- Verify that the JACK of the module is connected to the REMOTE input of the radio.



BUTTONS ON THE STEERING WHEEL	RADIO CD	
Roller or volume key	INCREASE VOLUME / DECREASE VOLUME	
Arrow up	SEEK +	TRACK +
Arrow down	SEEK —	TRACK —
Dot	MUTE	
Arrow or dotted line MODE	SOURCE	

CANBUS CONNECTIONS (SEEN FROM CABLE OUTPUT OF CONNECTORS)

SAAB 9.3-9.5
CONNECTIONS BEHIND
THE RADIO

FUNCTIONS

KEY	RADIO	CASSETTE	CD
+	VOLUME UP		
—	VOLUME DOWN		
	SEEK +	NEXT TRACK	
	SEEK —	PREVIOUS TRACK	

FUNCTIONS

KEY	RADIO	CASSETTE	CD		
+	VOLUME UP				
—	VOLUME DOWN				
▲	SEEK +	NEXT TRACK			
▼	SEEK —	PREVIOUS TRACK			
SRC	SOURCE				
▶	MUTE				

CANBUS CONNECTIONS OPEL CORSA D

To connect the canbus wire to the car it is necessary to do it directly to the display.
First of all remove the plastic panel shown below.

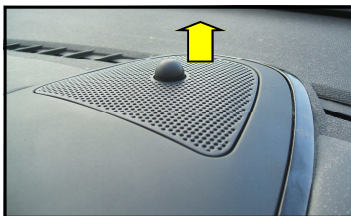

Once the panel is removed, please remove the torques that keeps the display chassis blocked.

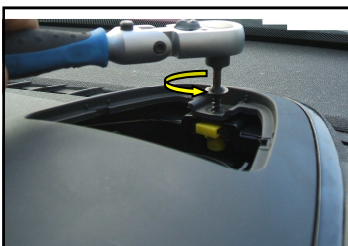

Once the torques is removed, detach the display with its plastic .

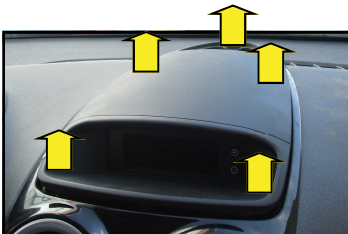

Now rotate the display so to have the acces to the connector of the display.

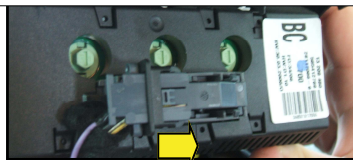
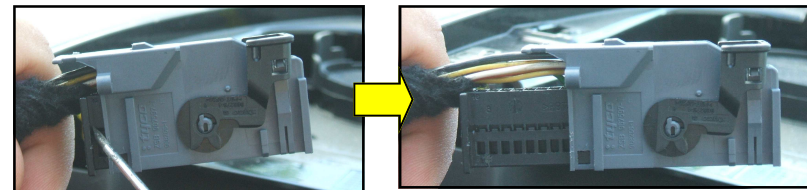

DIAGRAM OF CONNECTION

Once disconnected the plug from the display remove the connector inside as shown in the picture.



Now detect the GREEN wire and connect the GREEN wire of UNICAN 1C.

